

JETAWAY (1956 -1964)

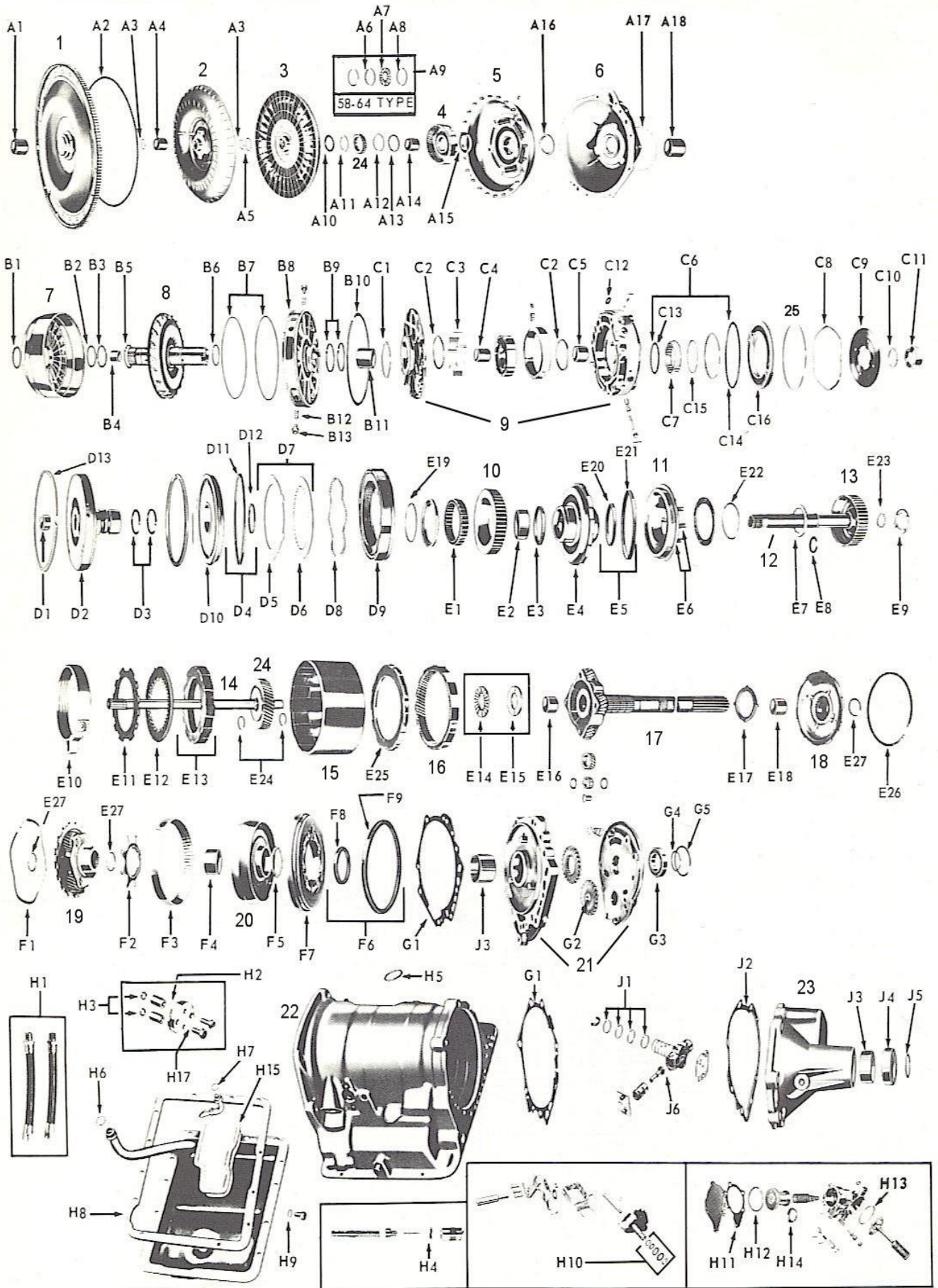

DESCRIPTION	YEAR	PART NUMBER	QTY	ILLUSTRATION #
KITS				
MASTER KIT w/clutches & steels	1956-1964	J102-1	1	NI
MAJOR KIT w/clutches	1956-1964	J102-2	1	NI
OVERHAUL KIT	1956-1964	J102-3	1	NI
EXTERNAL SEAL KIT	1956-1964	J102-4	1	NI
GASKETS				
PAN GASKET	1956-1959	H4-2	1	H8
PAN GASKET	1960-1964	H4-2A	1	H8
FILTERS				
FILTER SCREEN	1956-1958	H9-17	1	H15
FILTER SCREEN	1959	H10-17	1	H15
FILTER	1960-1964	H11-17	1	H15
O-RINGS				
TORUS COVER O-RING	1956-1964	D2-12	1	A2
LEVER SEAL SET	1956-1964	H105D	1	H10
COUPLING COVER O-RING	1956-1964	H11-5	2	B7
FILLER TUBE O-RING (Except Pontiac)	1956-1964	H10-12	1	H5
FILLER TUBE O-RING (Pontiac)	1958-1959	H11-12	1	H5
SEALS				
BELL HOUSING/FRONT SEAL	1956-1957	H8-9	1	A16
BELL HOUSING/FRONT SEAL	1958-1964	H10-9	1	A16
EXTENSION HOUSING REAR SEAL	1956-1964	H12-9	1	J4
BANDS				
REAR BRAKE BAND	1956-1964	H122D	1	E10
FRICTION PLATES				
OVERRUN CLUTCH FRICTION PLATE (.120")	1956-1964	H14-1	1	C9
NEUTRAL CLUTCH FRICTION PLATE (.087")	1956-1957	H5-1	5	D6
NEUTRAL CLUTCH FRICTION PLATE (.102")	1956-1964	H12-1	5	D6
REAR CLUTCH FRICTION PLATE (.102")	1956-1958	H7-1	7	E12
REAR CLUTCH FRICTION PLATE (.102")	1959-1964	H13-1	7	E12
STEEL PLATES				
NEUTRAL CLUTCH STEEL PLATE (.050")	1956-1964	H6-1	4	D5
REAR CLUTCH STEEL PLATE (.070")	1956-1964	H8-1	7	E11

BUSHINGS				
BUSHING KIT	1956-1957	KH106B	1	NI
BUSHING KIT	1958-1964	KH106C	1	NI
BELL HOUSING BUSHING	1956-1957	H31-6	1	A18
BELL HOUSING BUSHING	1958-1964	H31-6A	1	A18
EXTENSION HOUSING-1.250" LONG	1956-1964	5105L	1	J3
THRUST WASHERS				
THRUST WASHER KIT	1956	KH111A	1	NI
THRUST WASHER KIT	1957-1964	KH111B	1	NI
SEALING RINGS				
SEALING RING KIT	1956-1964	H104D	1	NI
NEW HARD PARTS				
COUPLING COVER	1956-1964	J105G	1	B8
FRONT SPRAG	1956-1964	J35A	1	C7
REAR SPRAG	1956-1964	J35	1	E1
REVERSE FIBER CONE	1956-1958	J41B	1	F3
REVERSE FIBER CONE	1959-1964	J41C	1	F3
REVERSE PISTON RELEASE SPRING	1956-1958	8616221	1	F1
REVERSE PISTON RELEASE SPRING	1959-1964	8619278	1	F1
DETENT ROLLER/SPRING	1956-1964	8619104	1	NI
OLDSMOBILE COOLER HOSE	1956-1959	574300	1-2	H1
OLDSMOBILE COOLER HOSE	1960	577336	1-2	H1
2/3 SHIFT SLIP KIT	1956-1964	J23	1	NI
REBUILT/USED HARD PARTS				
FLYWHEEL	1956-1964	CALL	1	1
DRIVEN TORUS	1956-1964	J105C	1	2
DRIVE TORUS	1956-1964	J105F	1	3
FRONT UNIT DRIVE GEAR	1956-1957	J109	1	4
FRONT UNIT DRIVE GEAR	1958-1964	J109A	1	4
TORUS BOWL	1956-1957	CNR-8	1	5
TORUS BOWL	1958-1964	CNR-9	1	5
BELL HOUSING	1956-1964	CALL	1	6
COUPLING DRIVE TORUS	1956-1957	J105D	1	7
COUPLING DRIVE TORUS	1958-1962	J105E	1	7
COUPLING DRIVEN TORUS	1956-1957	J105	1	8
COUPLING DRIVEN TORUS	1958-1962	J105B	1	8
FRONT PUMP ASSEMBLY	1956	J01	1	9
FRONT PUMP ASSEMBLY	1956-1960	J01A	1	9
FRONT PUMP ASSEMBLY	1957-1964	J01B	1	9
FRONT PUMP ASSEMBLY	1957-1964	J01C	1	9
CENTER SUPPORT	1956	J28	1	D2

CENTER SUPPORT	1957-1964	J28A	1	D2
CENTE SUPPORT	1957-1964	J28B	1	D2
NEUTRAL CLUTCH DRUM	1956	J05	1	D9
NEUTRAL CLUTCH DRUM	1956-1964	J05A	1	D9
REAR CLUTCH CYLINDER	1956-1964	J06	1	E4
INTERMEDIATE SHAFT	1956-1964	J25C	1	12
REAR CLUTCH HUB	1956-1964	J59	1	13
REAR CLUTCH HUB	1963-1964	J59A	1	13
MAINSHAFT 17-1/2"	1956-1964	J25	1	14
MAINSHAFT 16-15/16"	1956-1964	J25A	1	14
MAINSHAFT 16-3/8"	1956-1964	J25B	1	14
REAR SUN GEAR .823"	1956-1964	J52M	1	24
REAR SUN GEAR .760"	1956-1964	J52N	1	24
REAR CLUTCH DRUM	1956-1964	J06A	1	15
REAR INTERNAL GEAR	1956-1964	J14	1	16
OUTPUT SHAFT/PLANETARY ASSEMBLY	1956-1964	CALL	1	17
SUN GEAR FLANGE	1956	J19	1	18
SUN GEAR FLANGE	1957-1964	J19A	1	18
REVERSE PLANETARY	1956	J10	1	19
REVERSE PLANETARY	1957-1964	J10A	1	19
REVERSE CLUTCH RELEASE SPRING	1956-1964	8618886	1	F2
REVERSE INTERNAL GEAR	1956-1958	J13	1	20
REVERSE INTERNAL GEAR	1959-1964	J13A	1	20
REVERSE PISTON- 1 ST DESIGN	1956	J41D	1	F7
REVERSE PISTON	1956-1958	J41	1	F7
REVERSE PISTON	1959-1963	J41A	1	F7
REAR PUMP ASSEMBLY	1956-1958	J60	1	21
REAR PUMP ASSEMBLY	1956-1958	J60A	1	21
REVERSE CLUTCH HOUSING - VENTED	1959-1960	J60C	1	21
REVERSE CLUTCH HOUSING	1961-1964	J60D	1	21
TRANSMISSION CASE	1956-1964	CALL	1	22
EXTENSION HOUSING	1956-1964	CALL	1	23
TRANSMISSION PAN, CASE FILL	1956-1959	J48	1	26
TRANSMISSION PAN, PAN FILL	1956-1959	J48A	1	26
TRANSMISSION PAN, CASE FILL	1960-1964	J48C	1	26
TRANSMISSION PAN, PAN FILL	1960-1964	J48B	1	26
GOVERNOR	1956-1958	J32	1	J6
GOVERNOR	1959-1962	J32A	1	J6
VALVE BODY	1956-1964	CALL	1	NI