

C4 (1964 - 1981)

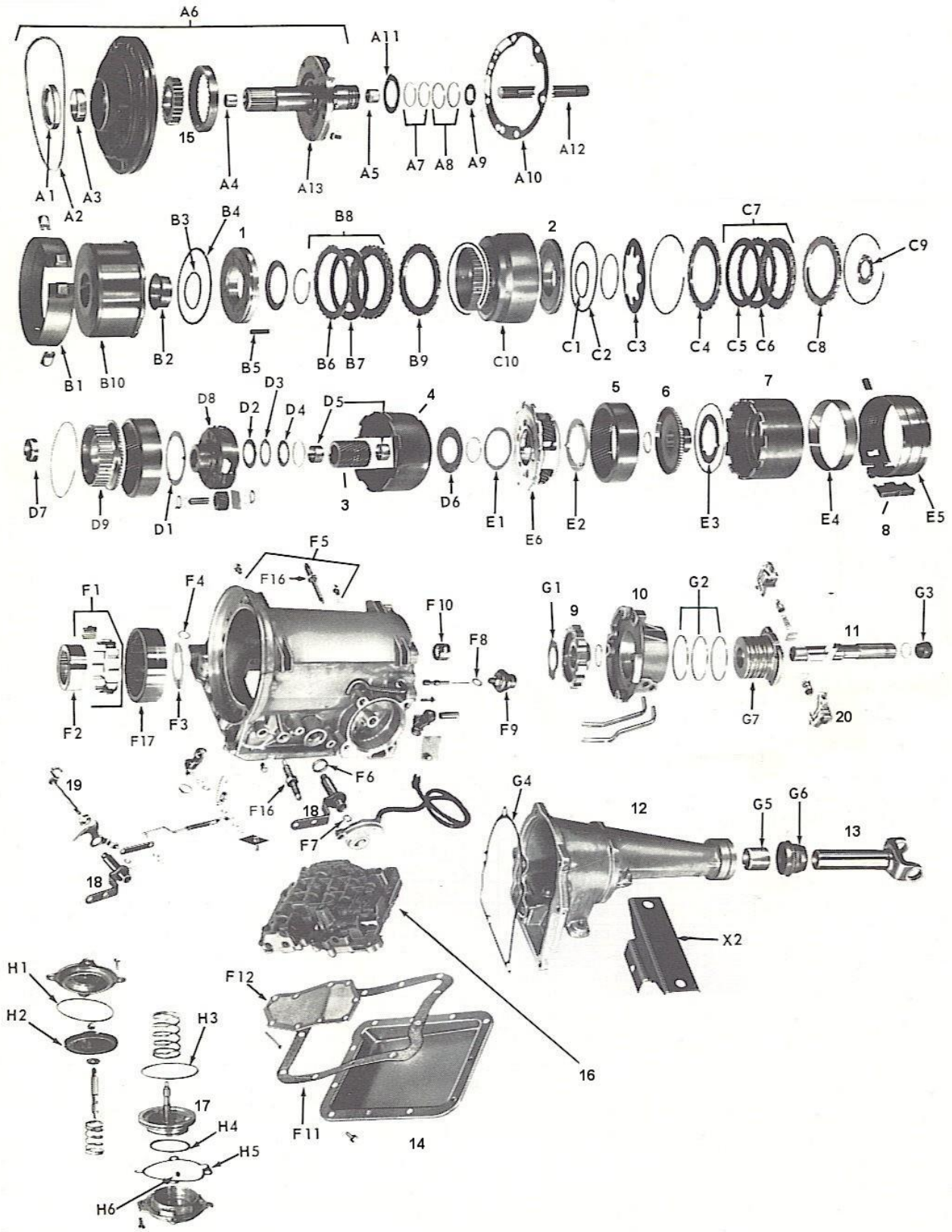

FORD

C4, C5

ILL	DESCRIPTION	YEARS	QTY	FATSCO	REFERENCE
-----	-------------	-------	-----	--------	-----------

REBUILDING KITS

DESCRIPTION	YEARS	MASTER KIT	MAJOR KIT	OVERHAUL KIT	PAPER/RUBBER
C4	1964	137-KX	237-KX	339-KX	
C4	65-69	138-KX	238-KX	339-KX	541-KX
C4	70-81	191-KX	291-KX	3412-KX	579-KX
C5	82-86	147-UX	247-UX	3403-UX	545-UX
HI-PERFORMANCE					
C4 - standard steels	65-69	1516-KX	2516-KX	339-KX	541-KX
C4 - Kolene® steels	65-69	1517-KX	2516-KX	339-KX	541-KX
C4 - standard steels	70-81	1518-KX	2518-KX	3412-KX	579-KX
C4 - Kolene® steels	70-81	1519-KX	2518-KX	3412-KX	579-KX

VALVE BODY KITS

NI	Shift Kit®	65-66	1	SFK-4L	SK®4L
	1967	1	SFK-4S	SK®4S
	68-69	1	SFK-4SL	SK®4SL
	70-72	1	SFK-71	SK®71
	- C4 & C5	73-86	1	SFK-C5	SK®C5
NI	Reprogramming Kit™ - Tow & Go	65-66	1	SFK-451	45-01
	- Tow & Go	67-69	1	SFK-471	47-1
	- Tow & Go	67-69	1	SFK-472	47-2
	- Tow & Go	70-81	1	SFK-402	40-2
NI	Reprogramming Kit™ - manual shift	67-69	1	SFK-473	47-3
	- manual shift	70-81	1	SFK-403	40-3

CLUTCH PLATES

FRICITION PLATES					
C5	Forward - .061"	64-86	4-5	1332-K	C8AZ-7B164D
	- .061" - hi-performance	64-86	4-5	1668-K	
B7	Direct - .090"	1964	3-4	1233-K	C4AZ-7B164D
	- .078"	65-86	3-4	1331-K	C5AZ-7B164B
	- .078" - hi-performance	65-86	3-4	1669-K	
STEEL PLATES					
C6	Forward - .078" - dull finish	64-67	3-4	1231-K	C4AZ-7B442C
	- .078"	68-86	3-4	1230-K	C4AZ-7B442B
	- .095" - oversized	64-86	ar	1287-K	
	- .078" - Kolene®	64-86	3-4	1670-K	
B6	Direct - .078"	64-81	3-4	1230-K	C4AZ-7B442B
	- .090" - C5	82-86	3-4	1196-U	E2SZ-7B442A
	- .095" - oversized	64-86	ar	1287-K	
	- .078" - Kolene®	64-86	3-4	1670-K	

PRESSURE PLATES

C8	Forward - .220" - flat	65-81	1	8626-K	C5AZ-7B066D
C4	- .267" - beveled	64-81	1	8671-K	C8AZ-7B066C
	- .313" - beveled	81-86	1	26307E	E1AZ-7B066A
B9	Direct - .220"	64-81	1	8626-K	C4AZ-7B066A
	- .141"	81-86	1	26307F	E1AZ-7B066B
	- .297"	82-86	1	26307G	E2SZ-7B066B

GASKETS

F11	Oil Pan - fiber	64-86	1	2423-K	D6OZ-7A191A
	- cork & rubber	64-86	1	2423-KCR	D6OZ-7A191A
A10	Front Pump to Case	64-86	1	2421-K	E1AZ-7A136A
NI	3-2 Timing Body - C5	82-86	1	2742-U	E2DZ-7F497A
NI	Valve Body	1964	1	2420-K	C4AZ-7D100B
	65-66	1	2098-K	C5AZ-7D100B
	67-69	1	2579-K	C9AZ-7D100A
	- L6 & V8	70-81	1	2607-K	D4OZ-7D100A
	- 4 cyl. & V6	70-81	1	2623-K	D4FZ-7D100B
	- C5	82-86	1	2741-U	E3DZ-7D100A
H5	Intermediate Servo Cover	64-86	1	2418-K	C4AZ-7D026C
F8	Vacuum Modulator - screw in	64-71	1	2514-F	C1AP-7B426A
G4	Extension Housing	64-86	1	2419-K	C4AZ-7086C
NI	Filter to Valve Body - deep pan only - metal	64-82	1	2099-K	D3BZ-7E062A

O'RINGS & RUBBER SEALS

A2	LCS, Front Pump to Case	64-66	1	4711-K	376950-S
NI	LCS, Intermediate Servo Cover	64-86	1	4703-K	C4AZ-7D024B
	LCS, Intermediate Servo - large - 3.390" ID	64-81	1	4184-K	D5TZ-7D024A
	- 2.807" ID	70-77	1	4829-K	DOAZ-7D024A
	- 2.867" ID	72-81	1	4185-K	D2DZ-7D024A
	- 3.273" OD	64-81	1	4732-K	C5ZZ-7D024A
	- 3.352" OD	64-77	1	4703-K	C4AZ-7D024B
	- 3.625" OD	64-77	1	4704-K	C4AZ-7D024A
	O'ring, Intermediate Servo - large - 3.487" ID	82-86	1	4729-U	E1AZ-7D024A
	LCS, Intermediate Servo - small - 1.823" ID	65-70	1	4733-K	C5DZ-7D025A
	- 1.945" ID	65-74	1	4758-K	C5ZZ-7D025A
	- 2.060" ID	64-77	1	4706-K	C4DZ-7D025A
	- 2.271" ID	64-81	1	4186-K	D9FZ-7D025A
	- 2.381" ID	64-81	1	4875-K	D9AZ-7D025A
	- 2.505" ID	64-81	1	4189-K	D5TZ-7D025A
	- 2.687" ID	65-68	1	4757-K	C5AZ-7D025A
	- 3.000" OD	64-81	1	4760-K	C8ZZ-7D025A
	- 2.733" OD	64-81	1	4707-K	C4OZ-7D025A
	- 2.875" OD	64-79	1	4705-K	C4AZ-7D025B
	O'ring, Intermediate Servo - small - 2.550" ID	82-86	1	4191-K	E1AZ-7D025A
	- 2.237" ID	82-86	1	4745-U	E2SZ-7D025A
	- 2.362" ID	82-86	1	4731-U	E2DZ-7D025A

FORD

C4, C5

ILL	DESCRIPTION	YEARS	QTY	FATSCO	REFERENCE
H1	LCS, Reverse Servo Cover	64-69	1	4708-K	C4AZ-7D404A
	70-86	1	4190-K	DOAZ-7D040A
NI	Ball, Valve Body Check	64-86	2-4	9272-K	C7AZ-7E195A
	O'ring, Oil Filler Tube	64-86	1	4702-BC	87034-S94
	O'ring, Throttle Control Lever	64-86	1	4617-F	386078-S
	Lobed Seal, Throttle Control Lever - repl. above .	64-86	opt	4066-AD	386078-S
NI	O'ring, Speedometer	64-86	1	4676-Z	87036-S94
	O'ring, Vacuum Modulator	72-86	1	4617-F	386078-S
	Hose, Vacuum Modulator	64-86	1	8155-K	C1AZ-7B087E
NI	O'ring, Oil Cooler Tubes	65-86	4	4759-S	380892-S94
	Check Valve - Int. Servo Accum - rubber	64-80	1	9268-K	C5AZ-7D376A
	Check Valve - Int. Servo Accum - plastic	81-86	1	4192-K	D9AZ-7D376A
	Grommet, Shift Cable - plastic	67-86	1	9293-F	D4AZ-7341A
CLUTCH PISTON SEALS					
C1	O'ring, Forward Clutch - inner	64-70	1	4653-F	B5AZ-7A294E
	70-86	1	4830-K	DOAZ-7A294A
C2	LCS, Forward Clutch - outer	64-79	1	4710-K	C4AZ-7A548C
	Lip Seal, Forward Clutch - outer	79-86	1	4967-K	D8OZ-7A548A
B3	O'ring, Direct Clutch - inner	64-67	1	4653-F	B5AZ-7A294E
	LCS, Direct Clutch - inner	68-69	1	4792-K	C8AZ-7D404B
	70-86	1	4831-K	DOAZ-7D404A
B4	LCS, Direct Clutch - outer	64-81	1	4709-K	C8AZ-7A548B
	Lip Seal, Direct Clutch - outer	82-86	1	4923-U	E1AZ-7A548A
MOLDED PISTONS					
H2	Reverse Servo Piston	64-86	1	8609-K	D1AZ-7D189A
METAL CLAD SEALS					
A1	Front Pump - w/o flange	64-86	1	3177-S	C2AZ-7A248A
	- w/flange	64-86	ar	3119-F	C3OP-7A248A
G6	Extension Housing - w/flange	64-86	1	3146-D	D5AZ-7052B
	- w/o flange	64-86	ar	3147-G	D5AZ-7052B
	- w/bolt on yolk	64-72	1	3136-K	C4UZ-7052A
	- w/long boot	64-86	ar	3217-F	D5AZ-7052B
	- w/short boot	64-86	ar	3139-K	D5AZ-7052B
F6	Manual Lever Shaft	64-86	1	3150-F	D5AZ-7B496A
BUSHINGS					
NI	Bushing Kit	64-69	1	5045-KX	
	70-86	1	5003-KX	
A3	Front Pump Body - bronze	64-86	1	5199-S	COAP-7B258A
	- babbit	64-86	1	5490-K	COAP-7B258A
A4	Stator Support - front	64-69	1	5289-K	C4AZ-7B261A
	70-86	1	5342-K	DOAZ-7B261A
A5	Stator Support - rear	64-69	1	5290-K	C4AZ-7D018B

		70-86	1	5343-K	DOAZ-7D018A
B2	Direct Drum	64-69	1	5291-K	C4AZ-7D046A
	Direct Drum	70-86	1	5344-K	DOAP-7D046B
D7	Forward Clutch Hub	66-86	1	5318-K	C6AZ-7E059A
D5	Sun Gear	64-86	2	5292-K	C4AZ-7D065A
E4	Reverse Brake Drum	64-86	1	5293-K	C4AZ-7D001A
F10	Case	64-86	1	5294-K	C4AZ-7025A
G5	Extension Housing	64-86	1	5060-F	B3TZ-7A034A
	- bearing	64-86	1	52100-K	C3AZ-7025B

WASHERS, BEARINGS, RACES & SHIMS

KITS					
NI	Washer Kit - less selectives	64-86	1	6075-KX	
	- front pump selective	64-66	1	6077-KX	
	- front pump selective	67-86	1	6087-KX	
	- forward clutch selective	70-on	1	6066-KX	
	- forward clutch selective	64-69	1	6078-KX	
	- rear sun gear	64-86	1	6063-KX	
WASHERS & SHIMS					
A11	Front Pump - w/o tangs - .040"	64-66	sel	6550-K	C4AZ-7D014A
	- w/o tangs - .050"	64-66	sel	6551-K	C4AZ-7D014B
	- w/o tangs - .072"	64-66	sel	6552-K	C4AZ-7D014C
	- w/o tangs - .089"	64-66	sel	6553-K	C4AZ-7D014D
	- w/o tangs - .106"	64-66	sel	6554-K	C4AZ-7D014E
	- w/tangs - .072" - green	67-86	sel	6583-K	DOAZ-7D014A
	- w/tangs - .089" - natural	67-86	sel	6584-K	DOAZ-7D014B
	- w/tangs - .106" - black	67-86	sel	6585-K	DOAZ-7D014C
	- w/tangs - .123" - yellow	67-86	sel	6586-K	DOAZ-7D014D
	- w/tangs - .140" - blue	67-86	sel	6231-K	DOAZ-7D014E
	- .020" - shim	66-86	sel	6943-K	
	- .030" - shim	66-86	sel	6240-K	
D1	Forward Clutch Hub to Front Planetary	64-71	1	6549-K	C4AZ-7A242A
C9	Forward Hub to Ring Gear - 3 tab	64-69	1	6494-K	C4AZ-7D090A
	- 3 tab	70-86	1	6592-K	DOAZ-7D090A
D6	Input Shell	64-86	1	6242-K	C4AZ-7D066B
D1/E1	Forward & Reverse Planetary	64-71	2	6549-K	C4AZ-7A242A
	- 3 inner tabs	72-86	2	6733-K	D2OZ-7A242A
E3	Reverse Drum to Rear Ring Gear	64-79	1	6548-K	C4AZ-7C096A
	80-86	2	6243-K	EOAZ-7C098B
G1	Parking Gear - 3 external slots	64-86	1	6236-K	C4AZ-7B368A
F3	Reverse Drum to Case	64-86	1	6511-K	EOAZ-7D072A
A9	Forward Clutch - .042"	70-86	sel	6734-K	DOAZ-7D091A
	- .057"	70-86	sel	6735-K	DOAZ-7D091B
	- .074"	70-86	sel	3736-K	DOAZ-7D091C
	- .042"	64-69	sel	6512-K	C4AZ-7D091A
	- .057"	64-69	sel	6513-K	C4AZ-7D091B

FORD

C4, C5

ILL	DESCRIPTION	YEARS	QTY	FATSCO	REFERENCE
	- .074"	64-69	sel	6514-K	C4AZ-7D091C
	- .091"	64-69	sel	6515-K	C4AZ-7D091E
	- .015" - shim	64-86	sel	6732-K	
	- .020" - shim	64-86	sel	6245-K	
	- .030" - shim	64-86	sel	6246-K	
	BEARINGS & RACES				
	Rear Sun Gear - 1pc type	64-86	1	6705-K	
	Bearing, Rear Sun Gear Needle	64-86	1	6493-K	C4AZ-7D234A
	Race, Rear Sun Gear Bearing - front	64-86	1	6492-K	C4AZ-7D236A
	Race, Rear Sun Gear Bearing - rear	64-86	1	6491-K	C4AZ-7D235A
SEALING RINGS					
NI	Sealing Ring Kit - C4	64-69	1	7056-KX	
	- C4 & C5	70-86	1	7074-KX	
	Stator Support to Forward Drum	64-69	2	7266-K	C4AZ-7D019B
	- .093" - metal ..	70-77	2	7305-K	DOAZ-7A019A
	- .125" - metal ..	78-86	2	7308-K	D7AZ-7D019A
	- .125" - Teflon .	78-86	2	7308-KT	D7AZ-7D019A
	Stator Support to Direct Drum	64-69	2	7267-K	C4AZ-7D020A
	- metal	70-86	2	7306-K	DOAZ-7D020A
	- Teflon	70-86	2	7306-KT	DOAZ-7D020A
	Governor Housing - metal	64-86	3	7265-K	C4AZ-7D011A
	- Teflon	64-86	3	7265-KT	C4AZ-7D011A
FILTERS					
F12	Filter - C4	1964	1	847-K	C4AZ-7A098B
	- C4	65-70	1	895-K	C5AZ-7A098C
	- C4	70-81	1	894-K	DODZ-7A098B
	- C4 - Dacron - high filtration	70-81	1	815-K	
	- C4 - deep pan - Mustang II & Pinto	74-81	1	883-K	D4FZ-7A098A
	- C4 - Bronco	73-77	1	885-K	D3BZ-7A098A
	- C5 - 2WD	82-86	1	ST-30	E2DZ-7A098A
	- C5 - 4WD	83-86	1	ST-33	E3TZ-7A098A
	Governor Screen	67-86	1	850-K	C7AZ-7E242E
NI	Filter Kit - C4	1964	1	763-KX	
	- C4	65-70	1	762-KX	
	- C4	70-81	1	761-KX	
	- C4 - Dacron - high filtration	70-81	1	470-KX	
	- C4 - deep pan - Mustang II & Pinto	74-81	1	733-KX	
	- C4 - Bronco	73-77	1	732-KX	
	- C5 - 2WD	82-86	1	740UX	
	- C5 - 4WD	83-86	1	730-UX	

BANDS

B1	Intermediate Band - 1.28" - solid	1964	1	BT-41	C4AZ-7D034C
	- 2.10" - solid	65-71	1	BT-44	C5AZ-7D034A
	- flex	65-86	1	BT-49	D9AZ-7D034C
	- snap in	65-86	1	BT-18	
E5	Reverse Band	64-86	1	BT-42	DOAZ-7D095A
F5	Band Adjusting Nut - coarse thread	64-86	1-2	9278-K	380850-S
	- C5 front - fine thread	81-86	1	9282-K	389049-S
NI	Strut, Front Flex Band	65-86	1-2	9518-K	-

MODULATORS

F9	Modulator - single diaphragm:				
	- screw in - white/green - adjustable	64-72	1	MT-63	C4AZ-7A377B
	- push in - yellow	72-81	1	MT-44	D2AZ-7A377-A
	- push in - yellow - adjustable	72-81	1	MT-91	D2AZ-7A377-A
	- push in - green - adjustable	75-81	1	MT30	D5AZ-7A377B
	- push in - white - adjustable	82-86	1	MT-14	E2TZ-7A377A
	Vacuum Modulator - dual diaphragm:				
	- push in - red	73-76	1	MT-45	D3OZ-7A377A
	- push in - red - adjustable	73-76	1	MT-34	D3OZ-7A377A

HARD PARTS - NEW

	PUMP PARTS				
15	Front Pump Gear Set	64-86	1	8172-K	C4AZ-7C010/011
NI	Anti-Balloon Sleeve Front Pump (bullet)	64-69	1	8174-K	
	SPRAGS & ROLLER CLUTCHES				
F1	Spring & Roller Kit	64-86	1	8550-K	C4AZ-7D089A
	Spring & Roller Kit with Cage	78-on	1	8403-K	-
	Cage Assembly	78-on	1	8816-K	D8OZ-7D191A
	SPRINGS				
C3	Disc Spring, Forward Clutch Piston	64-86	1	8624-K	E1AZ-7B070A
	Spring & Retainer, Direct Clutch	64-69	1	8173-K	C4AZ-7A480C
	Spring & Retainer, Direct Clutch	70-86	1	8118-K	DOAZ-7A480B
	SNAP RINGS				
	Forward & Direct Clutch - .052"	64-86	sel	12050-K	DOAZ-7A577B
	- .066"	64-86	sel	12051-K	D0AZ-7A577A
	- .080"	64-86	sel	12052-K	D0AZ-7A577C
	- .094"	64-86	sel	12053-K	D0AZ-7A577D
	- .106"	64-86	sel	12054-K	E1AZ-7A577B
	- waved	81-86	sel	12160-K	E1AZ-7A577A
2	Forward Clutch Piston	64-86	1	12055-K	C4AZ-7D256A
	MISCELLANEOUS				
D9	Clutch Hub, Forward	65-80	1	8809-K	C5AZ-7B067B
NI	Valve & Spring Kit, Oil Filter	71-on	1	9297-K	D5AZ-7E368A
F2	Inner Sprag Race	64-86	1	92100-K	D4AZ-7D171A
NI	Filler Tube Repair	64-86	1	96140	

FORD**C4, C5**

ILL	DESCRIPTION	YEARS	QTY	FATSCO	REFERENCE
ELECTRICAL COMPONENTS					
NI	Smog Switch	72-76	1	8582-K	D2AZ-7E440A
REBUILT & USED HARD PARTS					
A6	Front Pump with o-ring	64-E66	1	FC4-01	
A6	Front Pump without o-ring	64-E66	1	FC4-01A	
A6	Front Pump with o-ring	L66-69	1	FC4-01B	
A6	Front Pump without o-ring	L66-69	1	FC4-01C	
A6	Front Pump	70-77	1	FC4-01D	
A6	Front Pump	78-81	1	FC4-01E	
A12	Input Shaft, 24 x 24 spline	64-69	1	FC4-25A	
A12	Input Shaft, 26 x 26 spline	1970	1	FC4-25B	
A12	Input Shaft, 26 x 24 spline	71-81	1	FC4-25C	
B10	Direct Drum - short	64-E65	1	FC4-05	
B10	Direct Drum, 3 pack	65-69	1	FC4-05A	
B10	Direct Drum, 4 pack	65-69	1	FC4-05B	
B10	Direct Drum, 3 pack	70-81	1	FC4-05C	
B10	Direct Drum, 4 pack	70-81	1	FC4-05D	
B10	Direct Drum, 2 pack	70-81	1	FC4-05E	
1	Direct Piston, Casting #	64-81	1	CALL	
C10	Forward Drum, 4 pack	64-69	1	FC4-06	
C10	Forward Drum, 5 pack	64-69	1	FC4-06A	
C10	Forward Drum, 4 pack – 26 spline	1970	1	FC4-06B	
C10	Forward Drum, 5 pack – 26 spline	1970	1	FC4-06C	
C10	Forward Drum, 3 pack	71-81	1	FC4-06D	
C10	Forward Drum, 4 pack	71-81	1	FC4-06E	
C10	Forward Drum, 5 pack	71-81	1	FC4-06F	
2	Forward Piston	64-81	1	CALL	
D9	Forward Clutch Hub, without bushing	64-65	1	FC4-16	
D9	Forward Clutch Hub, with bushing	66-81	1	FC4-16A	
	Front Planetary Ring Gear	64-81	1	FC4-13	
D8	Front Planetary (use with FC4-16)	64-65	1	FC4-10	
D8	Front Planetary, 1-piece bearing	65-81	1	FC4-10A	
D8	Front Planetary, 3-piece bearing	65-81	1	FC4-10B	
3	Sun Gear	64-81	1	FC4-20	
4	Sun Shell	64-E65	1	FC4-22	
4	Sun Shell	L65-81	1	FC4-22A	
4	Sun Shell & Gear Assembly	L65-81	1	FC4-22B	
E6	Rear Planetary	64-81	1	FC4-11	
5	Rear Ring Gear	64-81	1	FC4-14	
6	Rear Ring Gear Hub	64-81	1	FC4-17	
7	Reverse Drum	64-81	1	FC4-07	

8	Reverse Band Strut	64-81	1	CALL	
F2	Inner Sprag Race	64-81	1	FC4-46	
F17	Outer Sprag Race	64-81	1	FC4-46A	
	Transmission Case	1964	1	FC4-36	Small servo
	Transmission Case w/vent tube	65-69	1	FC4-36A	
	Transmission Case w/vent, slope case	65-69	1	FC4-36B	
	Transmission Case	70-72	1	FC4-36C	Screw in modulator
	Transmission Case, slope case	70-72	1	FC4-36D	Screw in modulator
	Transmission Case	72-81	1	FC4-36E	Push in modulator
	Transmission Case, slope case	72-81	1	FC4-36F	Push in modulator
9	Parking Gear, 11 lugs 5/8" thick	64-81	1	FC4-47	
9	Parking Gear, 15 lugs 5/8" thick	64-81	1	FC4-47A	
9	Parking Gear, 15 lugs 7/16" thick	64-81	1	FC4-47B	
10	Governor Distribution Sleeve, Cast C5AP	64-69	1	FC4-34A	
10	Governor Distribution Sleeve, Cast D0AP	70-81	1	FC4-34B	
G7	Governor Support	64-81	1	FC4-34	
11	Output Shaft	64-81	1	CALL	
20	Governor, Cast# C4AP	64-81	1	FC4-32	
20	Governor, Cast# D1AP	70-81	1	FC4-32A	
18	Manual Lever Shaft, column shift	64-81	1	CALL	
18	Manual Lever Shaft, floor shift	64-69	1	FC4-67A	
18	Manual Lever Shaft, floor shift	70-81	1	FC4-67B	
19	Throttle Lever Shaft	64-69	1	FC4-74	
19	Throttle Lever Shaft	70-81	1	FC4-74A	
12	Extension Housing	64-81	1	CALL	
16	Valve Body	1964	1	FC4-33	
16	Valve Body	65-66	1	FC4-33A	Green Dot
16	Valve Body	67-69	1	FC4-33B	8 bolt
16	Valve Body	70-81	1	FC4-33C	9 bolt
16	Valve Body	70-71	1	FC4-33D	Pinto, 8 bolt
16	Valve Body	72-81	1	FC4-33E	Pinto, 9 bolt
	Intermediate Servo Assembly	1964	1	FC4-57	Small Pin
	Intermediate servo assembly – Casting #	65-81	1	CALL	
14	Transmission Oil Pan	64-81	1	CALL	

FORD

C4, C5

ILL	DESCRIPTION	YEARS	QTY	FATSCO	REFERENCE
-----	-------------	-------	-----	--------	-----------