

BW8 / BW12 CAST IRON CASE (1957-1977)

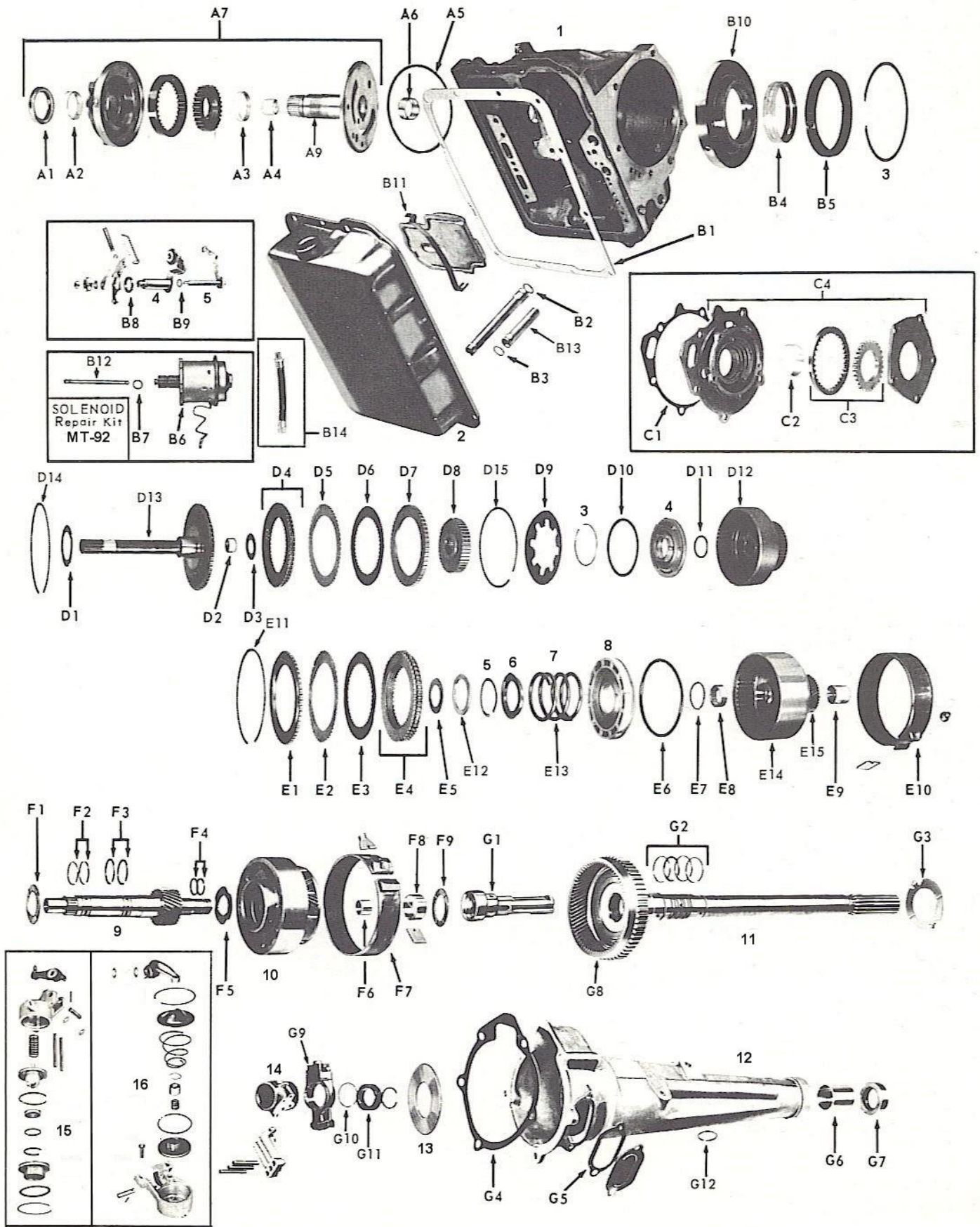

DESCRIPTION	YEAR	PART NUMBER	QTY	REF#/NOTES
KITS				
BW8 MASTER KIT W/CLUTCHES & STEELS	1957-1966	146-RX	1	NI
BW8 MAJOR KIT W/CLUTCHES	1957-1966	246-RX	1	NI
BW12 MASTER KIT W/CLUTCHES & STEELS	1967-1977	163-RX	1	NI
BW12 MAJOR KIT W/CLUTCHES	1967-1977	263-RX	1	NI
BW8/BW12 OVERHAUL KIT	1957-1977	371-RX	1	NI
GASKETS				
BW8/BW12 PAN GASKET	1957-1977	2261F	1	B1
BW8 EXTENSION HOUSING	1957-1966	2254F	1	G4
BW12 EXTENSION HOUSING	1967-1977	2591F	1	G4
REAR BEARING RETAINER - TRUCK	1957-On	2325F	1	NI
FILTER				
BW8 FILTER SCREEN	1957-1966	878F	1	B11
BW12 FILTER SCREEN	1967-1977	882F	1	B11
O-RINGS				
THROTTLE CONTROL LEVER	1957-1962	4690R	1	B9
THROTTLE CONTROL LEVER - STUDEBAKER	1957-1966	4617F	1	B9
FRONT PUMP O-RING	1957-1977	2253F	1	A5
SPEEDOMETER GEAR HOUSING	1963-1977	4676Z	1	NI
SEALS				
BW8/BW12 FRONT PUMP SEAL	1957-1977	3186F	1	A1
BW8 EXTENSION HOUSING SEAL-CLOSED DRIVELINE	1957-1966	3105H	1	G7
BW8 EXTENSION HOUSING SEAL-OPEN DRIVELINE	1957-1966	3146D	1	G7
BW12 EXTENSION HOUSING SEAL (2.438")	1967-1977	3167Q	1	G7
BW12 EXTENSION HOUSING SEAL-JAGUAR (3.125")		473468	1	G7
BW12 EXTENSION HOUSING SEAL-INTERNATIONAL		473463	1	G7
MANUAL LEVER SEAL	1957-1977	3150F	1	B8
BANDS				
BW8 FRONT BAND – OFFSET LUG (1-5/8")	1957-1977	F122	1	E10
BW8/BW12 FRONT BAND – OFFSET LUG (1-15/16")	1957-1977	BT-54	1	E10
BW12 FRONT BAND - CENTER LUG (1-15/16")	1968-1977	BT-55	1	E10
FRONT BAND – FLEX TYPE	1968-1977	BT-43	1	E10
REAR BAND	1957-1977	F122B	1	F7
FRICTIONS				
FRONT CLUTCH/FORWARD FRICTION PLATE (.060")	1957-1977	1272F	3-4	D6
REAR CLUTCH/DIRECT FRICTION PLATE (.076")	1957-1977	1276F	3-4	D6
FRONT/REAR FRICTION PLATE	1957-1977	1278F	AR	D6

STEELS				
FRONT CLUTCH/FORWARD STEELS (.068") - FLAT	1957-1977	1103F	3-4	D5
REAR CLUTCH/DIRECT STEELS - DISHED	1957-1977	1105F	4-6	D5
BUSHINGS				
BW8/BW12 BUSHING KIT	1957-1977	5038-RX	1	NI
FRONT PUMP BUSHING	1957-1977	5063F	1	A2
BW8 EXTENSION HOUSING, CLOSED DRIVELINE	1957-1966	5105L	1	G6
BW8 EXTENSION HOUSING, OPEN DRIVELINE	1957-1966	5060F	1	G6
BW12 EXTENSION HOUSING, EXCEPT 390 ENGINE	1967-1977	5306Q	1	G6
BW12 EXTENSION HOUSING W/390 ENGINE	1967-1977	5307Q	1	G6
WASHERS				
THRUST WASHER KIT	1957-1977	KF111	1	NI
SEALING RINGS				
BW8/BW12 SEALING RING KIT	1957-1977	7089-RX	1	NI
MODULATOR				
ELECTRIC SOLENOID/MODULATOR (RAMBLER)	1959-1965	MT-36	1	B6
MODULATOR (4.750" OVERALL LENGTH)	1967-1977	MT-35	1	NI
MODULATOR (2.250" OVERALL LENGTH)	1967-1977	MT-70	1	NI
MODULATOR REPAIR KIT (RAMBLER)	1959-1965	MT-92	1	NI
NEW HARD PARTS				
ELECTRIC CASE CONNECTOR	1957-1977	9294W	1	NI
FORWARD DRUM RETURN SPRING	1957-1977	9529F	1	D9
ELEMENT TYPE SPRAG	1958-1977	8126L	1	NI
SPRING & ROLLER TYPE SPRAG	1958-1977	8131L	1	NI
REBUILT/USED HARD PARTS				
FRONT PUMP ASSEMBLY – 17 SPLINE INPUT SHAFT	1957-1977	F01	1	A7
FRONT PUMP ASSEMBLY – 29 SPLINE INPUT SHAFT	1957-1977	F01A	1	A7
CENTER SUPPORT – SPRAG TYPE	1957-1977	F28A	1	B10
FRONT SERVO ASSEMBLY – HSG CAST #	1957-1977	CALL	1	15
REAR SERVO ASSEMBLY – HSG CAST #	1957-1977	CALL	1	16
TRANSMISSION PAN	1957-1977	CALL	1	2
OUTPUT SUPPORT	1957-1977	CALL	1	NI
INPUT SHAFT – 17 spline / .180"	1957-1977	F25	1	D13
INPUT SHAFT – 17 spline / .218"	1957-1977	F25-1	1	D13
INPUT SHAFT – 29 spline / .192"	1957-1977	F25A	1	D13
INPUT SHAFT – 29 spline / .218"	1957-1977	F25-A1	1	D13
FRONT CLUTCH HUB	1957-1977	CALL	1	D8
FRONT CLUTCH APPLY PLATE	1957-1977	CALL	1	D7

FRONT CLUTCH PISTON – CAST #	1957-1977	CALL	1	4
FRONT CLUTCH DRUM	1957-1977	F06A	1	D12
REAR CLUTCH PRESSURE PLATE	1957-1977	CALL	1	E1
REAR CLUTCH PISTON – CAST #	1957-1977	CALL	1	8
REAR CLUTCH DRUM	1957-1977	CALL	1	E14
SUN GEAR SHAFT, WASHER STYLE	1957-1977	F20A	1	9
SUN GEAR SHAFT, BEARING STYLE	1957-1977	F20B	1	9
SUN GEAR SHAFT, RAMBLER	1957-1977	F20H	1	9
PLANETARY, SPRING/ROLLER W/LOW STEP	1957-1977	F11L	1	10
PLANETARY, SPRING/ROLLER W/HIGH STEP	1957-1977	F11M	1	10
PLANETARY, SPRAG TYPE, HIGH STEP	1957-1977	F11O	1	10
REAR RING GEAR	1957-1977	F14F	1	G8
OUTPUT SHAFT	1957-1977	CALL	1	11
OIL DISTRIBUTION SLEEVE – CAST #	1957-1977	CALL	1	14
GOVERNOR – CAST #	1957-1977	CALL	1	G9
EXTENSION HOUSING – CAST #	1957-1977	CALL	1	12
PARKING PAWL – CAST #	1957-1977	CALL	1	NI
BELL HOUSING – CAST #	1957-1977	CALL	1	NI