

POWERFLITE (1953 - 1961)

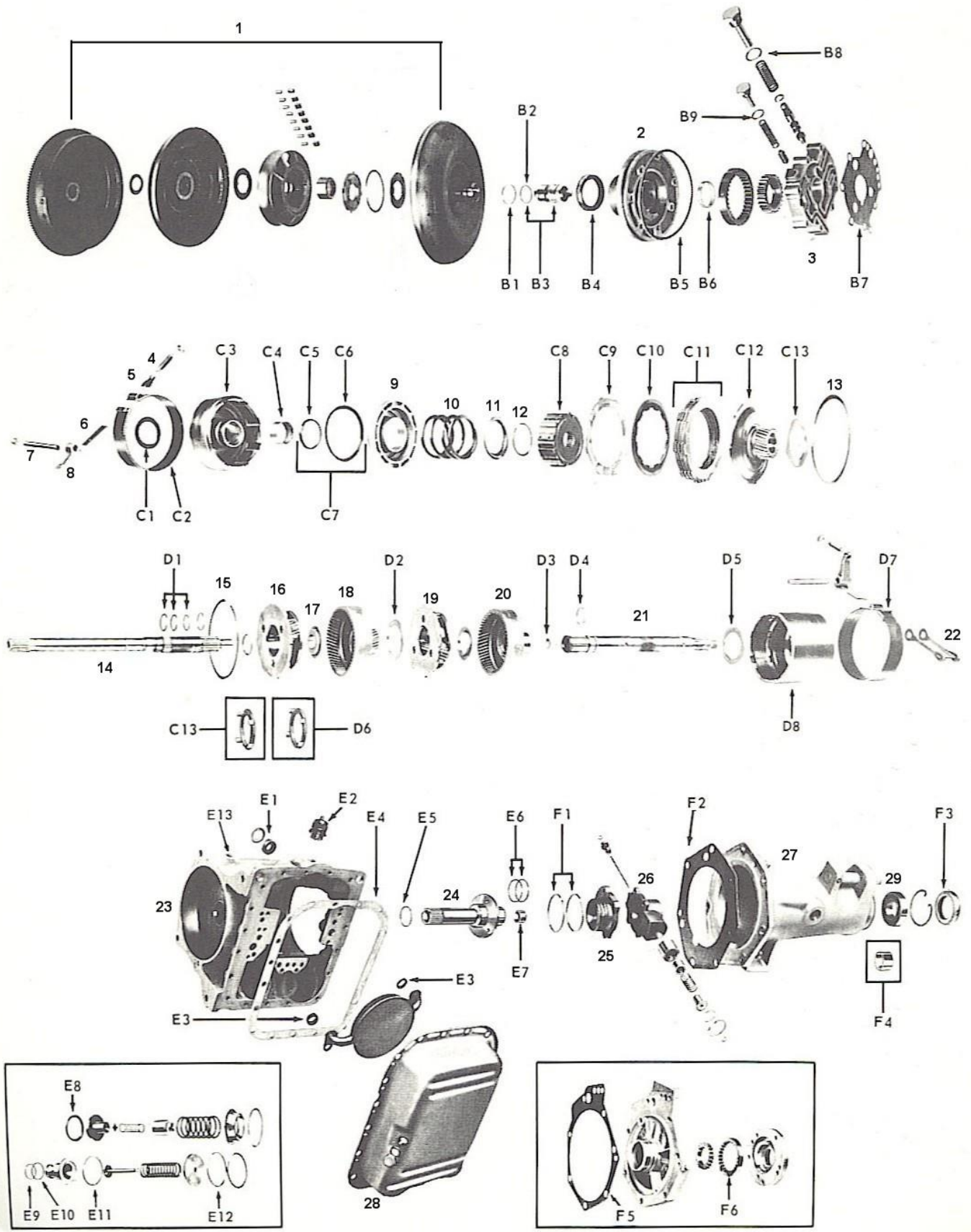

DESCRIPTION	YEAR	PART NUMBER	QTY	REF#/NOTES
KITS				
MASTER KIT W/CLUTCHES & STEELS	1953-1956	PF102-1	1	8 LUG FRICTION
MASTER KIT W/CLUTCHES & STEELS	1956-1961	PF102-1A	1	12 LUG FRICTION
MAJOR KIT W/CLUTCHES	1953-1956	PF102-2	1	8 LUG FRICTION
MAJOR KIT W/CLUTCHES	1956-1961	PF102-2A	1	12 LUG FRICTION
OVERHAUL KIT	1953-1961	PF102-3	1	
EXTERNAL SEAL KIT	1953-1961	PF102-4	1	
GASKETS				
PAN GASKET	1953-1961	C1-2	1	E4
EXTENSION HOUSING GASKET	1953-1961	C3-2	1	F2
FILTER				
FILTER SCREEN	1953-1961	C1-17	1	
O-RINGS				
PUMP O-RING	1953-1961	C6-5	1	B5
SEALS				
FRONT PUMP SEAL	1953-1961	C7-9	1	B4
EXTENSION HOUSING SEAL	1953-1961	C1-9	1	F3 (3167Q)
MANUAL LEVER SEAL	1953-1961	C3-9	1	E1
BANDS				
FRONT BAND	1953-1956	C122	1	C2 (anchor/strut type)
FRONT BAND	1956-1961	C122B	1	C2 (double strut type)
REAR BAND	1953-1958	C122E	1	D7 (shallow strut)
REAR BAND	1953-1961	C122G	1	D7 (deep strut)
FRICTIONS				
FRICTION PLATE	1953-1956	C2-1	6-7	C10 (8 lugs)
FRICTION PLATE	1956-1961	C1-1	7	C10 (12 lugs)
STEELS				
STEEL PLATE	1953-1961	C3-1	6-7	C9
BUSHINGS				
BUSHING KIT	1953-1961	KC106	1	NI
PUMP BUSHING	1953-1961	C3-6	1	B6
WASHERS				
THRUST WASHER KIT	1953-1961	KC111	1	NI

SEALING RINGS				
SEALING RING KIT	1953-1961	PF104	1	NI
NEW HARD PARTS				
EXTENSION HOUSING BEARING	1953-1956	206	1	29
EXTENSION HOUSING BEARING	1957-1961	206-1	1	29 (not available)
REBUILT/USED HARD PARTS				
FRONT PUMP DRIVE SLEEVE	1953-1956	PF103	1	B3 (sealing ring)
FRONT PUMP DRIVE SLEEVE	1956-1961	PF103A	1	B3 (rubber o-ring)
FRONT PUMP	1953-1961	PF01	1	2
PRESSURE REGULATOR BODY	1953-1956	PF104A	1	3
PRESSURE REGULATOR BODY	1956-1961	PF104	1	3
CLUTCH DRUM, inner sealing ring	1953-1955	PF06A	1	C3
CLUTCH DRUM, inner lip seal	1953-1961	PF06	1	C3
CLUTCH PISTON	1953-1961	CALL	1	9
CLUTCH HUB – 8 LUGS	1953-1956	PF59	1	C8
CLUTCH HUB – 12 LUGS	1956-1961	PF59A	1	C8
SUN GEAR FLANGE	1953-1961	PF19	1	C12
INPUT SHAFT, 3 RINGS, 1 SNAP RING	1953-1955	PF25	1	14
INPUT SHAFT, 2 SNAP RING	1956-1961	PF25A	1	14
INPUT SHAFT, 1 SNAP RING	1956-1961	PF25B	1	14
INPUT SHAFT, 1 SNAP RING	1956-1961	PF25C	1	14
FRONT PLANETARY – STEEL	1953-1961	PF10	1	16
FRONT PLANETARY – ALUMINUM	1953-1961	PF10A	1	16
FRONT RING GEAR	1953-1961	PF13	1	18
REAR PLANETARY – STEEL	1953-1961	PF11	1	19
REAR PLANETARY - ALUMINUM	1953-1961	PF11A	1	19
REAR RING GEAR w/ 1/8" STEP	1953-1961	PF14	1	20
REAR RING GEAR w/ 1/16" STEP	1953-1961	PF14A	1	20
OUTPUT SHAFT – COARSE SPLINE	1953-1961	PF52	1	21
OUTPUT SHAFT – FINE SPLINE	1953-1961	PF52A	1	21
REVERSE DRUM	1953-1956	PF07	1	D8
REVERSE DRUM	1956-1961	PF07A	1	D8
TRANSMISSION CASE	1953-1961	CALL	1	23
STATOR SHAFT, no internal bushing	1953-1961	PF03	1	24
STATOR SHAFT	1953-1955	PF03A	1	24
STATOR SHAFT	1953-1961	PF03B	1	24
GOVERNOR SUPPORT	1953-1961	PF34	1	25
GOVERNOR	1953-1961	PF32	1	26
EXTENSION HOUSING	1953-1961	CALL	1	27
TRANSMISSION PAN	1953-1961	PF48	1	28
REAR PUMP ASSEMBLY	1953-1961	PF60	1	
EMERGENCY BRAKE SHOES	1953-1961	PF113	1	

OUTPUT SUPPORT	1953-1961	PF106	1	
SPEEDOMETER HOUSING/GEAR	1953-1961	PF130	1	COUNT TEETH