

# SLIM JIM - ROTO 10 (1961 - 1964)

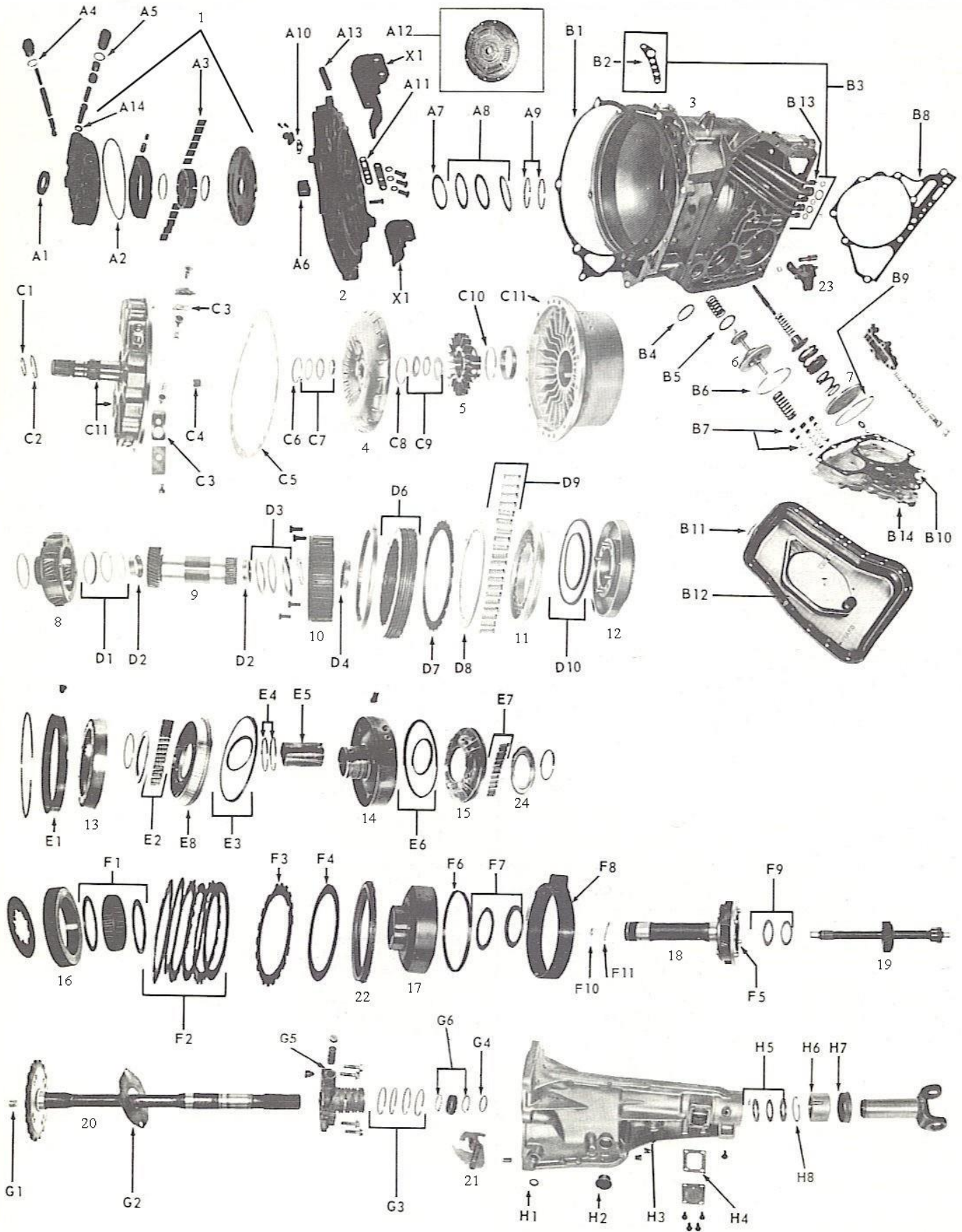

DESCRIPTION	YEAR	PART NUMBER	QTY	REF# / NOTES
<b>KITS</b>				
MASTER KIT W/CLUTCHES & STEELS	1961-1964	HS102-1	1	
MAJOR KIT W/CLUTCHES	1961-1964	HS102-2	1	
OVERHAUL KIT	1961-1964	HS102-3	1	
EXTERNAL SEAL KIT	1961-1964	HS102-4	1	
<b>GASKETS</b>				
PAN GASKET	1961-1964	HS4-2	1	B11
<b>FILTER</b>				
FILTER	1961-1964	HS750D	1	B12
<b>O-RINGS</b>				
FILTER O-RING	1961-1964	HF4-12	1	NI
FILLER TUBE O-RING (Oldsmobile)	1961-1964	H10-12	1	NI
FILLER TUBE O-RING (Pontiac)	1961-1964	H11-12	1	NI
SPEEDOMETER HOUSING - OUTER	1961-1964	4719E	1	NI
<b>SEALS</b>				
FRONT PUMP SEAL	1961-1964	HF1-9	1	A1
EXTENSION HOUSING SEAL	1961-1964	H12-9	1	H7 (3105H)
THROTTLE SHAFT SEAL	1961-1964	HS1-9	1	
MANUAL SHAFT SEAL	1961-1964	HS2-9	1	
<b>BAND</b>				
BAND	1961-1964	HS122	1	F8
<b>FRICTIONS</b>				
FRONT CLUTCH FRICTION	1961-1964	HS1-1	7	D7
NEUTRAL CLUTCH FRICTION	1961-1964	HS4-1	4	F4
<b>STEELS</b>				
FRONT CLUTCH STEEL	1961-1964	HS2-1	7	D8
NEUTRAL CLUTCH STEEL	1961-1964	HS5-1	4	F3
<b>BUSHINGS</b>				
BUSHING KIT	1961-1964	KHS106	1	NI
EXTENSION HOUSING BUSHING	1961-1964	5105L	1	H6
<b>WASHERS</b>				
THRUST WASHER KIT	1961-1964	KHS111	1	NI

<b>SEALING RINGS</b>				
SEALING RING KIT	1961-1964	HS104	1	NI
<b>NEW HARD PARTS</b>				
DAMPER PLATE	1961-1964	HS109	1	A12
BELL HOUSING PLUG	1961-1964	8620423	1	A13
REVERSE FIBER CONE	1961-1964	HS41B	1	E1
SPRAG ELEMENT	1961-1964	HS35	1	F1
REAR SUN GEAR DAMPER	1961-1964	HS20B	1	NI
<b>REBUILT/USED HARD PARTS</b>				
FRONT PUMP	1961-1964	HS01	1	1
BELL HOUSING	1961-1964	CALL	1	2
DRIVE TORUS W/DOWEL PINS	1961-1964	HS105	1	C11
DRIVE TORUS W/O DOWELS	1961-1964	HS105A	1	C11
DRIVEN TORUS	1961-1964	HS105B	1	4
MULTIPLIER	1961-1964	HS105C	1	5
TORUS COVER W/ HOLES FOR DOWEL	1961-1964	HS06	1	C11
TORUS COVER W/O HOLES FOR DOWEL	1961-1964	HS06-1	1	C11
FRONT PLANETARY	1961-1964	HS10	1	8
FRONT SUN GEAR	1961-1964	HS19	1	9
FRONT RING GEAR W/4 HOLES	1961-1964	HS13	1	10
FRONT RING GEAR W/2HOLES	1961-1964	HS13A	1	10
FRONT CLUTCH PISTON	1961-1964	HS39	1	11
FRONT CLUTCH DRUM – 4 PIN	1961-1964	HS06A	1	12
FRONT CLUTCH DRUM – 2 PIN	1961-1964	HS06B	1	12
REVERSE STEEL CONE	1961-1964	HS41A	1	13
REVERSE PISTON	1961-1964	HS41	1	E8
CENTER SUPPORT w/7/16" ANCHOR SLOT	1961-1964	HS28	1	14
CENTER SUPPORT w/3/8" ANCHOR SLOT	1961-1964	HS28A	1	14
NEUTRAL CLUTCH PISTON	1961-1964	HS40	1	15
OUTER SPRAG RACE	1961-1964	HS46	1	16
REAR RING GEAR – 61 TEETH	1961-1964	HS14	1	17
REAR RING GEAR – 58 TEETH	1961-1964	HS14A	1	17
REAR PLANETARY – 4 PIN/30TH/2 DOWEL	1961-1964	HS11	1	18
REAR PLANETARY – 4 PIN / 31TH /4 DOWEL	1961-1964	HS11A	1	18
REAR PLANETARY – 5 PIN/31TH/4 DOWEL	1961-1964	HS11B	1	18
REAR PLANETARY – 4 PIN/30 <sup>TH</sup> /4 DOWEL	1961-1964	HS11C	1	18
REAR SUN GEAR – 31TH	1961-1964	HS20	1	19
REAR SUN GEAR – 30TH	1961-1964	HS20A	1	19
MAINSHAFT	1961-1964	HS20C	1	
OUTPUT SHAFT – 18-7/8" – 4 HOLES	1961-1964	HS52	1	20
OUTPUT SHAFT – 15-7/8" – 4 HOLES	1961-1964	HS52A	1	20
OUTPUT SHAFT – 15-7/8" – 2 HOLES	1961-1964	HS52B	1	20
OUTPUT SHAFT – 15-7/8" – 2 HOLES	1961-1964	HS52C	1	20

GOVERNOR – ALUMINUM BODY	1961-1964	HS32	1	G5
GOVERNOR – CAST IRON BODY	1961-1964	HS32A	1	G5
EXTENSION HOUSING	1961-1964	CALL	1	H3
VALVE BODY	1961-1964	CALL	1	
TRANSMISSION PAN	1961-1964	HS48	1	
OIL PIPE ASSEMBLY	1961-1964	HS114	1	NI
OIL PIPE SAVER KIT	1961-1964	HS114A	1	NI