

# C6 (1966 - ON)

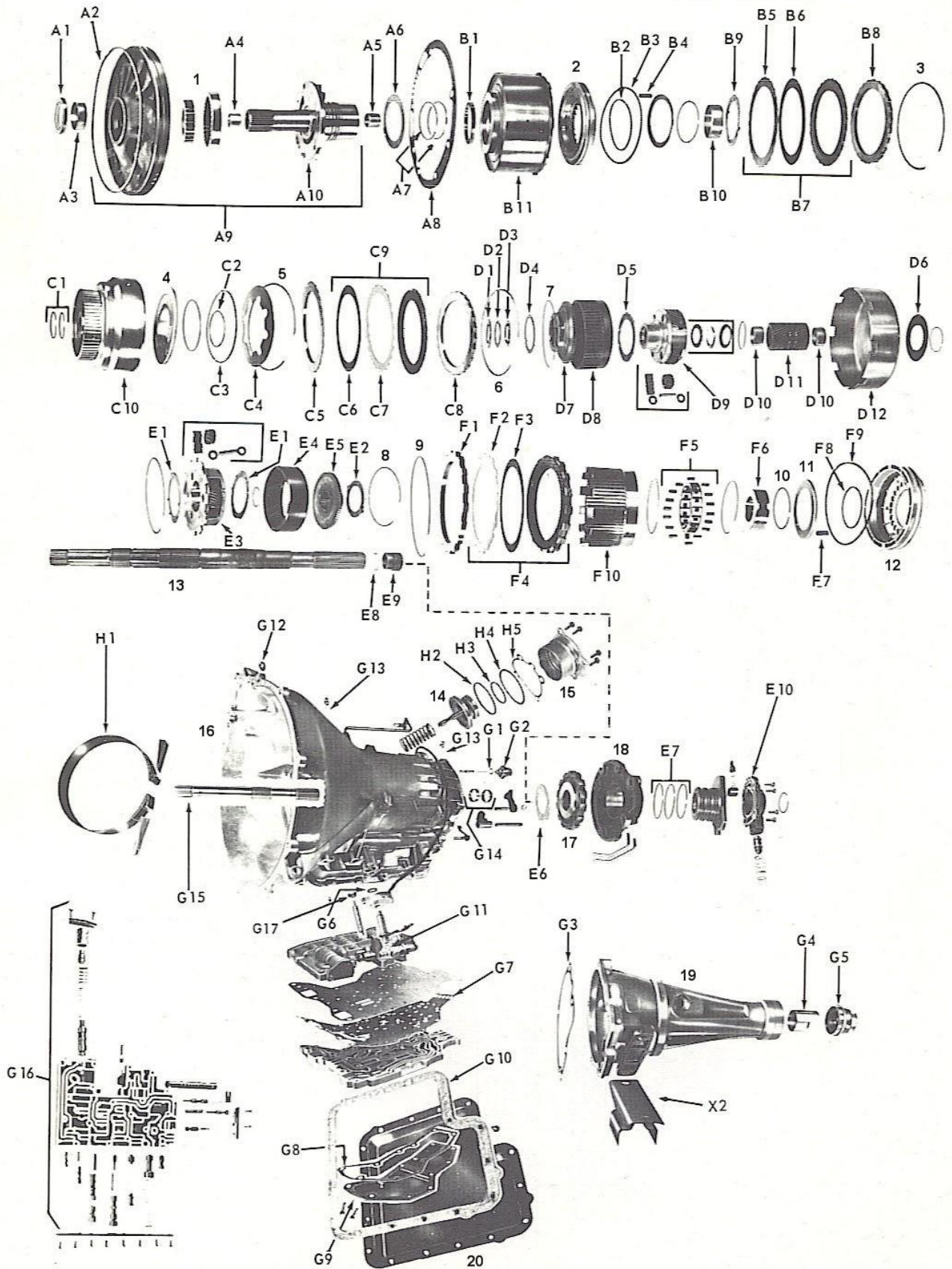

**FORD**

**C6**

ILL	DESCRIPTION	YEARS	QTY	FATSCO	REFERENCE
-----	-------------	-------	-----	--------	-----------

**REBUILDING KITS**

DESCRIPTION	YEARS	MASTER KIT	MAJOR KIT	OVERHAUL KIT	PAPER/RUBBER
C6 .....	66-67	153-NX	253-NX	335-NX	549-NX
C6 .....	68-76	154-NX	254-NX	335-NX	549-NX
C6 .....	76-on	194-NX	294-NX	3432-NX	508-NX
C6 - hardened spl. forward ....	76-on	1259-NX	2259-NX	3432-NX	508-NX
<b>HI-PERFORMANCE</b>					
C6 - standard steels .....	68-76	1520-NX	2520-NX	3432-NX	508-NX
C6 - Kolene® steels .....	68-76	1521-NX	2520-NX	3432-NX	508-NX
C6 - standard steels .....	76-on	1522-NX	2522-NX	3432-NX	508-NX
C6 - Kolene® steels .....	76-on	1523-NX	2522-NX	3432-NX	508-NX

**VALVE BODY KITS**

NI	Shift Kit® - gas & diesel .....	67-on	1	<b>SFK-6</b>	SK®6
NI	Reprogramming Kit™ - Tow & Go .....	67-on	1	<b>SFK-67-12</b>	67-1&2
	- manual shift .....	67-on	1	<b>SFK-67-3</b>	67-3
NI	Shift Correction Package .....	67-on	1	<b>STK-C6</b>	KC6

**CLUTCH PLATES**

<b>FRICION PLATES</b>					
C6	Forward - coarse spline - .060" .....	66-67	4-5	<b>1336-N</b>	C6AZ-7B164A
	- .061" .....	67-76	3-5	<b>1248-N</b>	D2AZ-7B164A
	- .075" .....	76-on	4-5	<b>1381-N</b>	D6AZ-7B164B
	- .075" - hardened spline .....	76-on	4-5	<b>1476-FD</b>	F2TP-7E311A
	- .060" - hi-performance .....	67-76	4-5	<b>1671-N</b>	-
	- .075" - hi-performance .....	76-on	4-5	<b>1672-N</b>	-
	- .075" - hi-perf. - hardened spline .....	76-on	4-5	<b>1950-N</b>	-
B6	Direct - .077" .....	66-on	3-4	<b>1254-N</b>	C8AZ-7B164H
	- .075" - hi-performance .....	66-on	3-4	<b>1673-N</b>	-
	- .062" - commercial .....	66-on	ar	<b>1951-N</b>	-
	- .062" - commercial hi-performance .....	66-on	ar	<b>1674-N</b>	-
F3	Reverse - .075" .....	66-on	4-6	<b>1252-N</b>	D6AZ-7B164A
	- .075" - hi-performance .....	66-on	4-6	<b>1675-N</b>	-
<b>STEEL PLATES</b>					
C7	Forward - .078" .....	66-67	4	<b>1245-N</b>	C6AZ-7B442A
	- .080" - waved .....	68-76	3-4	<b>1255-N</b>	C6AZ-7B442C
	- .078" .....	76-on	4	<b>1245-N</b>	C6AZ-7B442A
	- .095" - oversized .....	66-on	ar	<b>1106-N</b>	-
	- .078" - Kolene® .....	66-on	4	<b>1676-N</b>	-
	- .095" .....	66-on	ar	<b>1954-N</b>	-
B5	Direct - .078" .....	66-on	4	<b>1245-N</b>	C6AZ-7B442A
	- .095" - oversized .....	66-on	ar	<b>1106-N</b>	-
	- .078" - Kolene® .....	66-on	4	<b>1676-N</b>	-

	- .059" .....	66-on	ar	<b>1953-N</b>	-
	- .125" .....	66-on	ar	<b>1952-N</b>	-
F2	Reverse - .068" .....	66-on	4-6	<b>1246-N</b>	C6AZ-7B442B
	- .081" - oversized .....	66-on	ar	<b>1107-N</b>	-
	- .068" - Kolene® .....	66-on	4-6	<b>1677-N</b>	-
<b>CLUTCH PACKS</b>					
NI	Direct Clutch Powerpack™ .....	66-on	1	<b>26757</b>	-
<b>PRESSURE PLATES</b>					
C5	Forward Clutch - front - beveled .....	66-on	1	<b>8639-N</b>	C6AZ-7B066A
C8	Forward Clutch - rear - flat .....	66-on	1	<b>8634-N</b>	C6AZ-7B066B
B8	Direct Clutch - flat .....	66-on	1	<b>8634-N</b>	C6AZ-7B066B
F1	Reverse Clutch - .438" .....	66-on	1	<b>36415B</b>	C6AZ-7B066C
<b>GASKETS</b>					
G10	Oil Pan - fiber .....	66-on	1	<b>2572-N</b>	C6AZ-7A191B
	- cork & rubber .....	66-on	1	<b>2572-NCR</b>	C6AZ-7A191B
A8	Front Pump to Case .....	66-on	1	<b>2563-N</b>	EOAZ-7A136B
G7	Valve Body .....	1966	1	<b>2570-N</b>	C6AZ-7D100B
	- combo .....	67-on	1	<b>2520-N</b>	
H5	Intermediate Servo Cover .....	66-on	1	<b>2564-N</b>	D4AZ-7D026A
G3	Extension Housing .....	66-on	1	<b>2575-N</b>	C6AZ-7086A
G1	Vacuum Modulator - screw in .....	66-71	1	<b>2514-F</b>	C1AP-7B426A
G8	Filter - paper .....	66-on	1	<b>2571-N</b>	C6AZ-7E062A
	- metal .....	66-on	1	<b>2265-N</b>	C6AZ-7E062A
NI	Rear Bearing Retainer - truck .....	68-on	1	<b>2325-F</b>	B3TZ-7086A
<b>O'RINGS &amp; RUBBER SEALS</b>					
A2	LCS, Front Pump to Case .....	66-on	1	<b>4764-N</b>	D9AZ-7A248A
H2	Interm. Servo Piston - outer - round - 2.69" .....	66-74	1	<b>4775-N</b>	C6AZ-7D024E/H
	- V cut - 2.73" .....	66-74	1	<b>4774-N</b>	C6AZ-7D024F
	- round - 2.77" .....	66-68	1	<b>4776-N</b>	C6AZ-7D024G
	- round - 2.35" .....	71-74	1	<b>4847-N</b>	D2AZ-7D024A
	- round - 3.15" .....	68-71	1	<b>4827-N</b>	C8OZ-7D024A
H3	Interm. Servo Piston - inner - round - 1.69" .....	66-69	1	<b>4781-N</b>	C6AZ-7D025H
	- round - 1.76" ID ....	66-69	1	<b>4779-N</b>	C6AZ-7D025G
	- square - 2.05" ID ..	66-74	1	<b>4788-N</b>	C6AZ-7D025J
	- round - 2.05" ID ....	66-72	1	<b>4828-N</b>	C6AZ-7D025F
	- round - 1.79" ID ....	66-74	1	<b>4780-N</b>	C6AZ-7D025E
	- round - 2.06" ID ....	66-74	1	<b>4782-N</b>	
H4	LCS, Intermediate Servo Cover .....	66-on	1	<b>4784-N</b>	D5TZ-7D024B
NI	O'ring, Oil Filler Tube .....	66-on	1	<b>4702-BC</b>	87034-S94
NI	O'ring, Cooler Line to Case .....	66-on	2	<b>4786-N</b>	
NI	O'ring, Oil Cooler Tube .....	66-on	2	<b>4785-AD</b>	377159-S
NI	O'ring, Throttle Lever .....	66-on	1	<b>4617-F</b>	386078-S
NI	Lobed Ring, Throttle Lever - replaces above .....	66-on	1	<b>4066-AD</b>	386078-S
G1	O'ring, Vacuum Modulator - push in .....	72-on	1	<b>4617-F</b>	386078-S

**FORD**  
**C6**

ILL	DESCRIPTION	YEARS	QTY	FATSCO	REFERENCE
NI	O'ring, Speedometer .....	66-on	1	<b>4676-Z</b>	87036-S94
NI	Grommet, Shift Cable - plastic .....	66-on	1-2	<b>9293-F</b>	D4AZ-7341A
NI	Hose, Vacuum Modulator - curved .....	66-on	1	<b>8155-K</b>	D1ZZ-7E087A
<b>CLUTCH PISTON SEALS</b>					
	O'ring, Forward - inner- poly .....	66-on	1	<b>4774-N</b>	E9TZ-7A548A
	- Viton .....	66-on	1	<b>4230-HC</b>	E9TZ-7A548A
	LCS, Forward - outer .....	66-75	1	<b>4767-N</b>	C6AZ-7A548A
	Lip Seal, Forward - outer .....	76-on	1	<b>4965-N</b>	D6AZ-7A548A
NI	LCS, Direct - inner .....	66-67	1	<b>4766-N</b>	C6AZ-7C099A
	.....	68-on	1	<b>4790-N</b>	C8AZ-7C099A
NI	LCS, Direct - outer .....	66-on	1	<b>4789-N</b>	C8AZ-7A548C
	LCS, Low & Reverse - inner .....	66-67	1	<b>4770-N</b>	C6AZ-7D404A
	.....	68-on	1	<b>4826-N</b>	F3TZ-7D404A
	LCS, Low & Reverse - outer .....	66-on	1	<b>4791-N</b>	C6AZ-7D403A
<b>MOLDED PISTONS</b>					
14	Intermediate Servo - CA - 2.095" - L cover .....	66-74	1	<b>8950-N</b>	D5TZ-7D021A
	- BA - 1.980" - N cover .....	74-on	1	<b>9546-N</b>	D5UZ-7D021A
	- AA - 2.050" - S cover .....	74-on	1	<b>8925-N</b>	D7AZ-7D021A
	- DA - 2.130" - P cover .....	74-on	1	<b>9587-N</b>	D5TZ-7D021B
<b>METAL CLAD SEALS</b>					
A1	Front Pump Body - w/o flange .....	66-on	1	<b>3177-S</b>	C2AZ-7A248A
	- w/flange .....	66-on	1	<b>3119-F</b>	C3OZ-7A248A
G6	Manual Control Lever .....	66-on	1	<b>3150-F</b>	D5AZ-7B498A
G5	Extension Housing - w/o boot .....	66-on	1	<b>3105-H</b>	
	- w/boot .....	66-on	1	<b>3148-F</b>	D5AZ-7052A
	- truck .....	68-on	1	<b>3198-N</b>	B3TZ-7A011A
	- Lincoln .....	66-69	1	<b>3149-M</b>	C6VY-7052A
<b>BUSHINGS</b>					
NI	Bushing Kit .....	66-67	1	<b>5048-NX</b>	-
	.....	68-on	1	<b>5043-NX</b>	-
A3	Front Pump Body - bronze .....	66-on	1	<b>5309-N</b>	C6AZ-7B258A
	- babbitt .....	66-on	1	<b>5383-FF</b>	-
A4	Stator Support - front - 1.0005" .....	66-67	1	<b>5310-N</b>	C6AZ-7B261A
	- 1.0105" .....	68-on	1	<b>5151-N</b>	C8AZ-7B261C
A5	Stator Support - rear - 1.0005" .....	66-67	1	<b>5339-N</b>	C6AZ-7D018A
	- 1.0105" .....	68-on	1	<b>5152-N</b>	C8AZ-7D018A
B1	Direct Drum - front - narrow .....	66-on	1	<b>5311-N</b>	C6AZ-7D046B
B10	Direct Drum - rear - wide .....	66-on	1	<b>5312-N</b>	C6AZ-7D046A
D10	Sun Gear .....	66-on	2	<b>5313-N</b>	C6AZ-7D065A
G14	Case - front - w/oil groove .....	66-on	1	<b>5314-N</b>	C6AZ-7025D
	- hardened - w/oil groove .....	66-on	1	<b>52201-N</b>	F2TZ-7025A
G14	Case - rear - w/o oil groove .....	66-on	1	<b>5340-N</b>	C8AZ-7025B

G4	- hardened - w/o oil groove .....	66-on	1	<b>52202-N</b>	F5TZ-7025A
	Extension Housing - babbit .....	66-on	1	<b>5058-F</b>	B5AZ-7A034A
	- bronze .....	66-on	1	<b>5307-Q</b>	-
	- Lincoln .....	66-69	1	<b>5218-M</b>	C1VY-7A034A
	- truck .....	68-on	1	<b>52203-N</b>	8D7065

### WASHERS, BEARINGS, RACES & SHIMS

<b>KITS</b>					
NI	Washer Kit - less selectives .....	66-on	1	<b>6073-NX</b>	-
	- front pump - metal .....	66-on	1	<b>6074-NX</b>	-
	- front pump - plastic .....	66-on	1	<b>6026-NX</b>	-
<b>WASHERS &amp; SHIMS</b>					
A5	Front Pump - #1 - .057" - metal .....	66-on	sel	<b>6523-N</b>	C6AZ-7D014A
	- #2 - .074" - metal .....	66-on	sel	<b>6524-N</b>	C6AZ-7D014B
	- #3 - .089" - metal .....	66-on	sel	<b>6525-N</b>	C6AZ-7D014C
	- #4 - .104" - metal .....	66-on	sel	<b>6526-N</b>	C6AZ-7D014D
	- #5 - .119" - metal .....	66-on	sel	<b>6527-N</b>	C6AZ-7D014E
	- #1 - .057" - plastic .....	66-on	sel	<b>6123-N</b>	C6AZ-7D014A
	- #2 - .074" - plastic .....	66-on	sel	<b>6124-N</b>	C6AZ-7D014B
	- #3 - .089" - plastic .....	66-on	sel	<b>6125-N</b>	C6AZ-7D014C
	- #4 - .104" - plastic .....	66-on	sel	<b>6126-N</b>	C6AZ-7D014D
	- #5 - .119" - plastic .....	66-on	sel	<b>6127-N</b>	C6AZ-7D014E
B9	Intermediate Brake Drum - 4 tabs .....	66-on	1	<b>6528-N</b>	C6AZ-7C096A
D4	Forward Clutch Drum - 3 tabs metal .....	66-on	1	<b>6530-N</b>	C9AZ-7D090A
D6	Input Shell - .049" .....	66-on	1	<b>6535-N</b>	C6AZ-7D066B
E1	Forward & Reverse Carrier - 6 tabs .....	66-on	3	<b>6531-N</b>	C6AZ-7A166A
E1	Reverse Carrier - 4 tabs .....	66-on	2	<b>6532-N</b>	C6SZ-7A166A
E2	Output Shaft Hub - 2 tabs .....	66-69	1	<b>6533-N</b>	C6AZ-7D422B
	- 3 tabs .....	69-on	1	<b>6582-N</b>	C9AZ-7D442A
E6	Output Shaft - rear park gear .....	66-on	1	<b>6534-N</b>	D3TZ-7B368A
NI	Overrun Clutch Roller .....	66-on	1	<b>6248-N</b>	-
<b>BEARINGS &amp; RACES</b>					
	Overrun Race to Hub - 3 pc. bearing .....	88-on	1	<b>6244-N</b>	E6DZ-7G178A
	Sun Gear - bearing .....	66-on	1	<b>6477-N</b>	C6AZ-7D234A
	Sun Gear - race .....	66-on	1	<b>6536-N</b>	-
	Sun Gear Package - 3 pc. design .....	66-75	1	<b>6704-NX</b>	C6AZ-7D234A
	- 1 pc. design .....	76-on	1	<b>6901-N</b>	EOAZ-7F231A

### SEALING RINGS

NI	Sealing Ring Kit - metal .....	66-on	1	<b>7068-NX</b>	-
	- teflon .....	66-on	1	<b>7039-NX</b>	-
	Stator Support - metal .....	66-on	2	<b>7281-N</b>	C6AZ-7D025A
	- teflon .....	66-on	2	<b>72201-N</b>	C6AZ-7D025A
	Forward Drum - metal .....	66-on	2	<b>7282-N</b>	C6AZ-7D019B
	- teflon .....	66-on	2	<b>72202-N</b>	C6AZ-7D019B
	Governor Housing - metal .....	66-on	3	<b>7265-K</b>	C4AZ-7D011A
	- teflon .....	66-on	3	<b>7265-KT</b>	C4AZ-7D011A

**FORD**  
**C6**

ILL	DESCRIPTION	YEARS	QTY	FATSCO	REFERENCE
<b>FILTERS</b>					
G9	Filter .....	66-75	1	<b>880-N</b>	C6AZ-7A098A
	.....	76-on	1	<b>881-N</b>	D5AZ-7A098A/B
	- truck .....	73-on	1	<b>888-N</b>	D3TZ-7A098A/B
NI	Valve Body Screen .....	70-on	1	<b>919-N</b>	DOAP-7E387A
NI	Tube, Filter - 4X4 .....	73-on	1	<b>36423T</b>	D3TZ-7A102C
NI	Filter Kit .....	66-75	1	<b>772-NX</b>	-
	.....	76-on	1	<b>773-NX</b>	-
	- truck .....	73-on	1	<b>726-NX</b>	-
<b>BANDS</b>					
H1	Intermediate Band - flex .....	66-on	1	<b>BT-62</b>	D9AZ-7D034B
	- snap in .....	66-on	1	<b>BT-19</b>	-
	- narrow - solid .....	66-67	1	<b>BT-83</b>	C6AZ-7D034A
	- wide - solid .....	68-on	1	<b>BT-89</b>	-
NI	Intermediate Band Strut .....	66-69	1	<b>9080-N</b>	-
NI	Band Adjusting Nut .....	66-on	1	<b>9274-N</b>	375185-S100
<b>MODULATORS</b>					
G2	Modulator - white - screw in .....	66-72	1	<b>MT-63</b>	C4AZ-7A377B
	- black - push in .....	73-on	1	<b>MT-31</b>	D3TZ-7A377A
	- purple - push in .....	75-on	1	<b>MT-80</b>	D5AZ-7A377A
	- green - push in .....	77-on	1	<b>MT-95</b>	D7AZ-7A377A
<b>HARD PARTS - NEW</b>					
	<b>PUMP PARTS</b>				
1	Front Pump Gear Set .....	66-on	1	<b>8177-N</b>	C6AP-7C010B
	<b>SPRAGS &amp; ROLLER CLUTCHES</b>				
F5	Spring & Roller Kit - .....	66-on	1	<b>8132-N</b>	DOAZ-7A089A
	- plastic .....	66-on	1	<b>36960B</b>	F3TZ-7A089A
	<b>SPRINGS</b>				
	Servo Spring .....	66-on	1	<b>92200-N</b>	-
C4	Forward Clutch Diaphragm - .076" .....	66-E76	1	<b>8669-N</b>	D9AZ-7B070A
	- .094" .....	L76-on	1	<b>8820-N</b>	D6AZ-7B070A
NI	Forward Clutch - waved .....	L76-on	1	<b>92201-N</b>	D6AZ-7E085B
NI	Accumulator Spring Set .....	66-on	1	<b>FC6-98</b>	-
	<b>SNAP RINGS</b>				
	Forward & Direct - .050" .....	66-on	sel	<b>12056-N</b>	377136-S
	- .058" .....	66-on	sel	<b>12057-N</b>	377437-S
	- .067" .....	66-on	sel	<b>12058-N</b>	377126-S
	- .076" .....	66-on	sel	<b>12059-N</b>	377127-S
	- .085" .....	66-on	sel	<b>12060-N</b>	377128-S
	- .094" .....	66-on	sel	<b>12061-N</b>	377444-S
	- .112" .....	66-on	sel	<b>12062-N</b>	386841-S

	- .130" .....	66-on	sel	<b>12063-N</b>	386842-S
NI	Sun Gear .....	66-on	1	<b>12064-N</b>	377300-S
NI	Output Shaft Hub .....	66-76	1	<b>12065-N</b>	377137-S
	.....	77-on	1	<b>12066-N</b>	387031-S5
NI	Reverse Pressure Plate .....	66-on	1	<b>12067-N</b>	377134-S
NI	Reverse Clutch Piston .....	66-on	1	<b>12068-N</b>	377133-S
NI	Direct Clutch Retainer .....	66-on	1	<b>12069-N</b>	C6AZ-7D256A
NI	Governor Support .....	66-on	1	<b>12070-N</b>	387035-S
NI	Output Shaft to Governor .....	66-on	1	<b>12071-N</b>	377138-S
<b>MISCELLANEOUS</b>					
F6	Overrun Clutch Race - inner - 1.089" .....	66-87	1	<b>8130-N</b>	C9AZ-7D171A
	- inner - 1.013" - race only	88-on	1	<b>36430</b>	-
	- inner - 1.013" - w/bearing	88-on	1	<b>K36430</b>	E9AZ-7D171A
NI	Kit, Rear Hub, Race & Bearing .....	88-on	1	<b>K36434</b>	-
NI	Modulator Pin Kit .....	66-on	1		D3AZ-7A380B
	Filler Tube Repair .....	66-on	1	<b>96140</b>	-

### HARD PARTS – REBUILT / USED

A9	Front Pump Assembly	66-on	1	<b>FC6-01</b>	
B11	Direct Drum, 3 pack	66-on	1	<b>FC6-05</b>	
B11	Direct Drum, 4 pack	66-on	1	<b>FC6-05A</b>	
C10	Forward Clutch Drum, 31 spline – 3 pack	66-71	1	<b>FC6-06</b>	
C10	Forward Clutch Drum, 31 spline – 4 pack	66-71	1	<b>FC6-06A</b>	
C10	Forward Clutch Drum, 31 spline – 5 pack	66-71	1	<b>FC6-06B</b>	
C10	Forward Clutch Drum, 30 spline – 3 pack	71-76	1	<b>FC6-06C</b>	
C10	Forward Clutch Drum, 30 spline – 4 pack	76-on	1	<b>FC6-06D</b>	
C10	Forward Clutch Drum, 30 spline – 5 pack	76-on	1	<b>FC6-06E</b>	
4	Forward Clutch Piston, lathe cut seal design	66-75	1	<b>FC6-39</b>	
4	Forward Clutch Piston, lip seal design	76-on	1	<b>FC6-39A</b>	
D7	Hub sold as part of item # D8	-	1	-	
D8	Front Ring Gear	66-67	1	<b>FC6-13</b>	
D8	Front Ring Gear	68-76	1	<b>FC6-13A</b>	
D8	Front Ring Gear	77-on	1	<b>FC6-13B</b>	
D9	Front Planetary, open face bearing	66-75	1	<b>FC6-10</b>	
D9	Front Planetary, closed face bearing	76-on	1	<b>FC6-10A</b>	
D11	Sun Gear	66-on	1	<b>FC6-20</b>	
D12	Sun Shell	66-on	1	<b>FC6-22</b>	
E3	Rear Planetary, 3 pinion	66-on	1	<b>FC6-11</b>	
E3	Rear Planetary, 4 pinion	66-on	1	<b>FC6-11A</b>	
E4	Rear Planetary Ring Gear	66-on	1	<b>FC6-14</b>	
E5	Rear Ring Gear Hub, long spline, 2 tab	66-E67	1	<b>FC6-17</b>	
E5	Rear Ring Gear Hub, short spline, 2 tab	L67-77	1	<b>FC6-17A</b>	
E5	Rear Ring Gear Hub, 3 tab	78-on	1	<b>FC6-17B</b>	
F10	Reverse Drum	66-on	1	<b>FC6-07</b>	
F6	Inner Sprag Race, w/o lube hole, washer style	66-69	1	<b>FC6-46</b>	

**FORD****C6**

ILL	DESCRIPTION	YEARS	QTY	FATSCO	REFERENCE
F6	Inner Sprag Race, w/lube hole, washer style	70-87	1	FC6-46A	
F6	Inner Sprag Race, bearing style	88-on	1	FC6-46B	
11	Reverse Spring Retainer Set	66-E76	1	FC6-49	
11	Reverse Spring Retainer Cage	L76-E86	1	FC6-49A	
11	Reverse Spring Retainer Cage	L86-on	1	FC6-49B	
12	Reverse Piston	66-E76	1	FC6-41	
12	Reverse Piston	L76-on	1	FC6-41A	
13	Output Shaft	1966-on	1	CALL	
G15	Input Shaft, 31 x 31 spline	66-E71	1	FC6-25A	
G15	Input Shaft, 30 x 31 spline	L71-on	1	FC6-25	
16	Transmission Case (302/351C/351W, screw in mod.)	66-72	1	FC6-36	
16	Transmission Case (302/351C/351W, push in mod.)	73-on	1	FC6-36A	
16	Transmission Case (351M/460, screw in mod.)	66-72	1	FC6-36B	
16	Transmission Case (351M/460, push in mod.)	73-on	1	FC6-36C	
16	Transmission Case (round bell, FE engine screw mod)	66-72	1	FC6-36D	
16	Transmission Case (round bell, FE engine push mod)	73-on	1	FC6-36E	
16	Transmission Case (diesel, push in modulator)	73-on	1	FC6-36F	
16	Transmission Case (tear drop screw in mod.)	66-72	1	FC6-36G	
16	Transmission Case (tear drop push in mod.)	73-on	1	FC6-36H	
G16	Valve Body, Green Dot, starts in 2 <sup>nd</sup> gear	1966	1	FC6-33	
15	Servo Cover	66-on	1	CALL	
G16	Valve Body, Detent in VB	67-69	1	FC6-33A	
G16	Valve Body, Detent in Case	70-77	1	FC6-33B	
G16	Valve Body – Gas Engine	78-on	1	FC6-33C	
G16	Valve Body – Diesel Engine	78-on	1	FC6-33D	
17	Parking Gear, 14 lug	66-on	1	FC6-47	
17	Parking Gear, 12 lug	66-on	1	FC6-47A	
18	Governor Distribution Sleeve	66-on	1	FC6-34A	
E10	Governor – Gas	66-on	1	FC6-32	
E10	Governor - Diesel	66-on	1	FC6-32A	
19	Extension Housing	66-on	1	CALL	
20	Transmission Pan, shallow	66-on	1	FC6-48	
20	Transmission Pan, 2x4 deep	66-on	1	FC6-48A	
20	Transmission Pan, 4x4 extra deep	66-on	1	FC6-48B	



