

TORQUEFLITE 6 (1960 - ON)

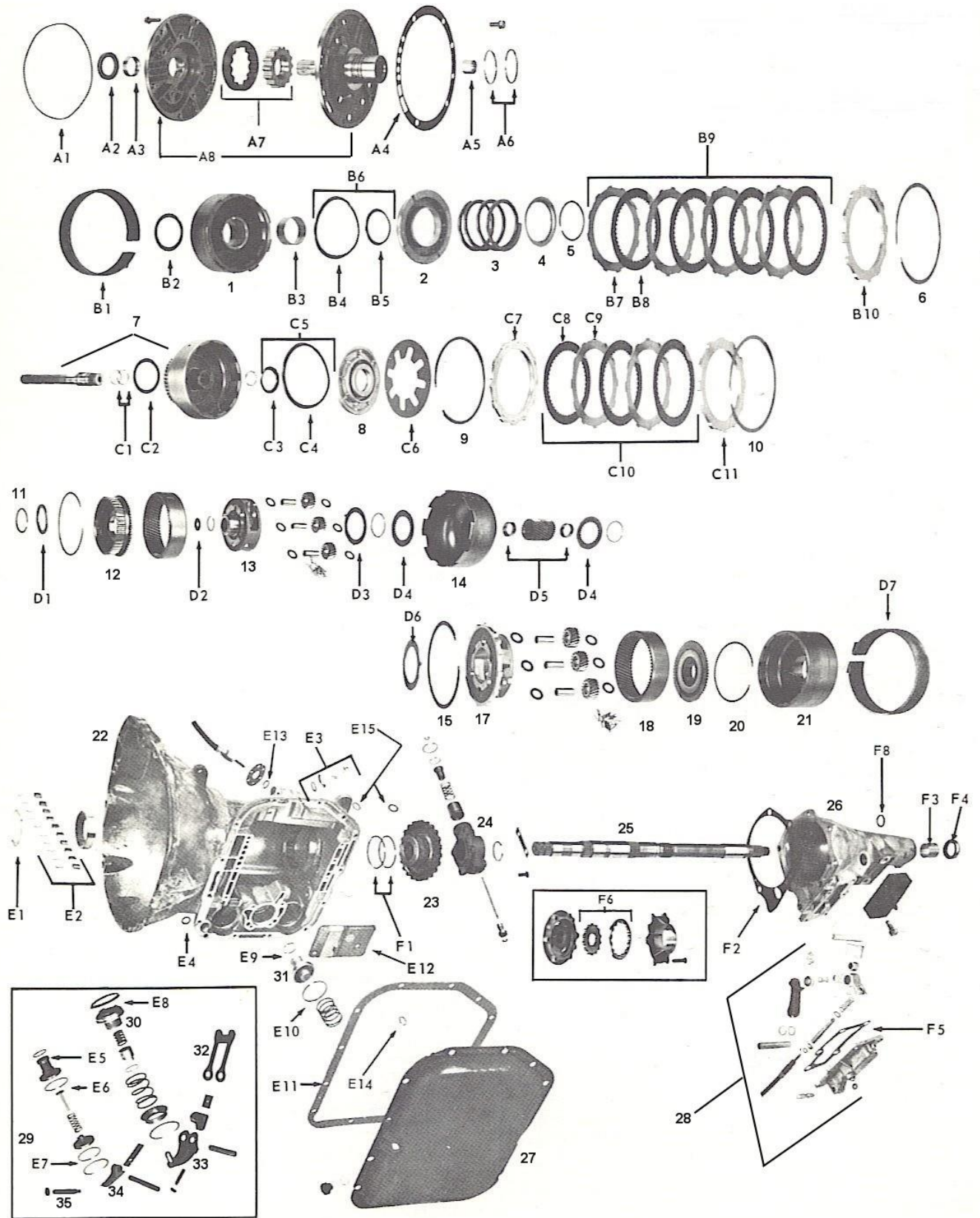

CHRYSLER

A904, A998, A999

| ILL | DESCRIPTION | YEARS | QTY | FATSCO | REFERENCE |
|-----|-------------|-------|-----|--------|-----------|
|-----|-------------|-------|-----|--------|-----------|

REBUILDING KITS

| DESCRIPTION | YEARS | MASTER KIT | MAJOR KIT | OVERHAUL KIT | PAPER/RUBBER |
|------------------------------|-------|------------|-----------|--------------|--------------|
| TF6 | 60-71 | 157-QX | 257-QX | 358-QX | |
| TF6 | 72-on | 185-QX | 285-QX | 357-QX | |
| TF6 - Import | 74-87 | 104-QX | 204-QX | 316-QX | |
| HI-PERFORMANCE | | | | | |
| A904 - standard steels | 72-on | 1526-QX | 2526-QX | 357-QX | |
| A904 - Kolene® steels | 72-on | 1527-QX | 2526-QX | 357-QX | |

VALVE BODY KITS

| | | | | | |
|----|--------------------------------------|-------|---|-----------------|-----------|
| NI | NoYoYo® Command Service Kit™ | 65-on | 1 | SFK-TFSC | SK®TF-SC™ |
| NI | Reprogramming Kit™ - Tow & Go™ | 60-on | 1 | SFK-TF1 | TF-1 |
| | - Competition | 60-on | 1 | SFK-TF2 | TF-2 |
| | - Stick Shift | 60-on | 1 | SFK-TF3 | TF-3 |
| NI | Kit, Lock-up Plate & Spring | 78-on | 1 | 9502-Q | 4186185 |

CLUTCH PLATES

| FRICITION PLATES | | | | | |
|-------------------------|---|-------|-----|---------------|---------|
| B8 | Direct - .086" | 60-on | 3-5 | 1322-Q | 4617362 |
| | - .086" - hi-performance | 60-on | 3-5 | 1687-Q | - |
| C8 | Forward - .061" - smooth | 60-on | 3-4 | 1323-Q | 4531068 |
| | - .061" - parallel line - Jeep only | 92-on | 3-4 | 1134-Q | 4713880 |
| | - .061" hi-performance | 60-on | 3-4 | 1688-Q | - |
| STEEL PLATES | | | | | |
| B7 | Forward & Direct - .068" | 60-on | 8 | 1184-Q | 4617325 |
| | - .088" - oversized | 60-on | ar | 1300-Q | - |
| | - .068" - Kolene® | 60-on | 8 | 1689-Q | - |

PRESSURE PLATES

| | | | | | |
|-----|-------------------------------------|-------|---|---------------|---------|
| B10 | Front Clutch - flat | 60-on | 1 | 8607-Q | 2801969 |
| C7 | Rear Clutch - front - beveled | 60-on | 1 | 8690-Q | 2466281 |
| C11 | Rear Clutch - rear - flat | 60-on | 1 | 8607-Q | 2801969 |

GASKETS

| | | | | | |
|-----|--------------------------------------|-------|---|---------------|----------|
| E11 | Oil Pan - fiber | 60-on | 1 | 2390-Q | 4295875 |
| | - Import - fiber | 74-80 | 1 | 2672-Q | 3681438 |
| | Front Pump to Case | 60-on | 1 | 2338-Q | 52118266 |
| | Oil Pan Drain Plug | 60-65 | 1 | 2504-Q | 2268513 |
| F2 | Extension Housing | 60-65 | 1 | 2406-Q | 2205322 |
| | | 66-on | 1 | 2535-Q | 2466954 |
| | Output Shaft Inspection Cover | 66-on | 1 | 2589-Q | 2801398 |
| | Parking Lock Cover | 60-62 | 1 | 2402-Q | 2298548 |
| | | 62-65 | 1 | 2403-Q | 2205207 |
| | Brass Oil Filter - foam rubber | 60-on | 1 | 2407-Q | 2205202 |

O'RINGS & RUBBER SEALS

| | | | | | | |
|---------------------------------|---|-------|---------------|----------------|---------|--|
| A1 | LCS, Pump to Case | 60-61 | 1 | 4606-Q | 1942384 | |
| | | 61-on | 1 | 4622-Q | 2204709 | |
| | Lip Seal, Reverse Servo | 64-on | 1 | 4139-Q | 2464462 | |
| | | 60-64 | 1 | 4086-Q | 1942499 | |
| | - Import | 74-87 | 1 | 4970-Q | 3681433 | |
| | Seal, Throttle Lever Shaft | 60-on | 1 | 4334-Q | 2466548 | |
| | Seal, Reverse Blocker Valve | 60-65 | 1 | 4697-Q | 2204885 | |
| | Seal, Speedometer Shaft - w/o spring | 66-on | 1 | 4822-E | - | |
| | - with spring | 66-on | 1 | 4819-BC | - | |
| | - Viton™ | 66-on | 1 | 4796-Q | 2538588 | |
| | | 60-65 | 1 | 4696-Q | 2124328 | |
| | O'ring, Neutral Safety Switch | 60-64 | 1 | 4692-Q | 1316849 | |
| | Washer, Neutral Safety Switch | 68-on | 1 | 4273-Q | 2408143 | |
| | O'ring, Filler Tube | 60-on | 1 | 4702-BC | 1316815 | |
| | O'ring, Selector Cable/Trans | 60-65 | 1 | 4693-Q | 1316813 | |
| | O'ring, Park Lock Cable | 60-65 | 1 | 4701-Q | 1536268 | |
| | O'ring, Speedometer Housing | 66-on | 1 | 4797-Q | 6025752 | |
| | - silicone | 66-on | 1 | 4547-Q | 6031370 | |
| | | 60-65 | 1 | 4695-Q | 1942259 | |
| | O'ring, Reverse Band Shaft | 68-on | 1-2 | 4690-R | 1556385 | |
| | O'ring, Kickdown Piston - inner - 6 cyl. | 78-on | 1 | 4860-Q | 6031410 | |
| | - 8 cyl. | 78-on | 1 | 4948-Q | 6028864 | |
| | O'ring, Solenoid | 87-on | 1 | 4973-I | - | |
| | Washer, Front Pump Bolt | 60-on | 6 | 9270-C | 6023943 | |
| | CLUTCH PISTON SEALS | | | | | |
| | Lip Seal, Direct - inner | 72-on | 1 | 4162-Q | 3515176 | |
| | | 60-71 | 1 | 4084-Q | 1942396 | |
| | Lip Seal, Direct - outer | 72-on | 1 | 4163-Q | 3515177 | |
| | | 60-71 | 1 | 4079-Q | 1942397 | |
| | Lip Seal, Forward - inner | 68-on | 1 | 4161-Q | 2538510 | |
| | 60-67 | 1 | 4142-Q | 2125187 | | |
| - to trans 184159 | 1960 | 1 | 4087-Q | 1942412 | | |
| Lip Seal, Forward - outer | 68-on | 1 | 4141-Q | 2538695 | | |
| | 60-67 | 1 | 4079-Q | 1942397 | | |

METAL CLAD SEALS

| | | | | | |
|---------------------------------|-------------------------------------|-------|---------------|---------------|---------|
| A2 | Front Pump | 60-on | 1 | 3152-Q | 3515138 |
| F4 | Extension Housing - with boot | 73-on | 1 | 3216-Q | 4058047 |
| | - w/o boot | 73-on | 1 | 3112-Q | 3515384 |
| | - with boot | 66-72 | 1 | 3192-Q | 2400163 |
| | - w/o boot | 66-72 | 1 | 3152-Q | |
| | | 1965 | 1 | 3189-Q | 2464482 |
| | | 60-64 | 1 | 3142-Q | 1942401 |
| | - w/ bolt on yolk | 73-on | 1 | 3167-Q | 2205080 |
| Manual Control Shaft Seal | 66-on | 1 | 3193-Q | 3878447 | |
| - heavy duty | 66-on | 1 | 3114-Q | 2466842 | |

BUSHINGS

CHRYSLER

A904, A998, A999

| ILL | DESCRIPTION | YEARS | QTY | FATSCO | REFERENCE |
|-----|-----------------------------------|-------|-----|---------|-----------|
| NI | Bushing Kit | 78-on | 1 | 5010-QX | - |
| | | 66-77 | 1 | 5049-QX | - |
| | | 60-65 | 1 | 5040-QX | - |
| A3 | Front Pump Housing - bronze | 60-on | 1 | 5192-Q | 2466796 |
| | - babbit | 60-on | 1 | 5255-Q | 2204953 |
| | Reaction Shaft | 78-on | 1 | 5497-Q | 4058635 |
| | | 68-77 | 1 | 5316-Q | 2801728 |
| | | 60-67 | 1 | 5253-Q | 2205302 |
| | Direct Drum | 60-on | 1 | 5317-Q | 2801727 |
| | Reverse Sun Gear | 60-on | 2 | 5214-Q | 1942436 |
| | Extension Housing | 66-on | 1 | 5306-Q | 2801726 |
| | | 60-65 | 1 | 5195-Q | 2124607 |
| | Front Annulus Gear | 78-on | 1 | 5480-Q | 3681967 |

WASHERS, BEARINGS, RACES & SHIMS

| | | | | | |
|----------------------------|--------------------------------------|-------|--------|---------|---------|
| KITS | | | | | |
| NI | Washer Kit - less selectives | 79-on | 1 | 6015-QX | - |
| | - less selectives | 68-78 | 1 | 6086-QX | - |
| | - less selectives | 60-67 | 1 | 6061-QX | - |
| | - selective | 79-on | 1 | 6020-QX | - |
| | - selective | 76-78 | 1 | 6025-QX | - |
| | - selective | 60-76 | 1 | 6060-QX | - |
| WASHERS & SHIMS | | | | | |
| | Front Clutch - front & rear | 71-on | 2 | 6612-Q | 3410572 |
| | - front & rear | 60-70 | 2 | 6489-Q | 2204369 |
| | Front Annulus Gear Support | 79-on | 1 | 6938-Q | 3681969 |
| | | 68-78 | 1 | 6556-Q | 2538696 |
| | | 60-67 | 1 | 6465-Q | 1942447 |
| | Overrunning Clutch Race | 60-65 | 1 | 6488-Q | 2400528 |
| | Plate, Driving Shell | 60-on | 1-2 | 6613-Q | 3410540 |
| | Planet Carrier - 3 tabs, 6 cyl | 76-on | 2 | 6715-Q | 3743027 |
| | - 4 tabs, 8 cyl | 76-on | 2 | 6712-Q | 3681935 |
| | - 3 tabs, 6 cyl | 68-75 | 2 | 6557-Q | 2801356 |
| | - 4 tabs, 8 cyl | 68-75 | 2 | 6606-Q | 2538515 |
| | - 3 tabs | 60-67 | 2 | 6488-Q | 2400528 |
| | Front Planetary - 2.625" | 80-on | 2 | 63001-Q | 4130518 |
| | Output Shaft - .052" - 2 tabs | 79-on | sel | 6744-Q | 4269196 |
| | - .068" - 2 tabs | 79-on | sel | 6750-Q | 4269197 |
| | - .083" - 2 tabs | 79-on | sel | 6755-Q | 4269198 |
| | - .052" - 1 tab | 76-78 | sel | 6716-Q | 3878777 |
| | - .068" - 1 tab | 76-78 | sel | 6717-Q | 3878778 |
| - .083" - 1 tab | 76-78 | sel | 6718-Q | 3878779 | |
| - .052" - natural | 60-76 | sel | 6485-Q | 2538669 | |

| | | | | | |
|-----------------------------|-------------------------------------|-------|-----|---------------|---------|
| | - .068" - red | 60-76 | sel | 6486-Q | 2538670 |
| | - .083" - black | 60-76 | sel | 6487-Q | 2538671 |
| | - thrust race | 79-on | 1 | 6800-Q | 4058982 |
| BEARINGS & RACES | | | | | |
| | Output Shaft - roller bearing | | | 206 | |
| PLANETARY REPAIR | | | | | |

SEALING RINGS

| | | | | | |
|----|---|-------|-----|----------------|---------|
| NI | Sealing Ring Kit | 60-on | 1 | 7048-QX | |
| | Reaction Shaft - 2.0625" hook | 60-on | 2 | 7233-Q | 1942389 |
| | Input Shaft - small - 1.0625" butt | 60-on | 1-2 | 7187-P | 1941831 |
| | - 1.0625" hook | 60-on | 1 | 7505-Q | 1401221 |
| | Input Shaft - large - 1.5600" hook | 78-on | 1 | 7215-Q | 4028333 |
| | - 1.5000" hook | 68-77 | 1 | 7199-Q | 1323593 |
| | Governor Support - 2.2500" butt | 60-on | 2 | 7235-Q | 1942109 |
| | Kickdown Piston - small - 1.2500" hook | 60-on | 1 | 7188-P | 1672287 |
| | - w/318 eng. - 1.0000" .. | 71-on | 1 | 7314-Q | 3410374 |
| | Kickdown Piston - large - 2.1250" butt | 60-on | 1 | 7206-Q | 1636470 |
| | - w/318 eng. - 2.3750" ... | 71-on | 1 | 7315-Q | 3410372 |
| | Kickdown Piston Rod Guide - 2.1250" | 60-on | 1 | 7206-Q | 1636470 |
| | - w/318 - 2.3750" ... | 71-on | 1 | 7315-Q | 3410372 |
| | Accumulator Piston - small - 1.0625" butt | 60-on | 1 | 7187-P | 1941831 |
| | Accumulator Piston - large - 2.0000" butt | 60-on | 1 | 7234-Q | 1315158 |

FILTERS

| | | | | | |
|-----|---------------------------------|-------|---|---------------|---------|
| E12 | Filter - large Dacron | 68-on | 1 | ST-17 | 3515996 |
| | - small Dacron | 60-67 | 1 | ST-12 | 3621456 |
| | - large brass | 68-on | 1 | ST-11 | 3515996 |
| | - small brass | 60-67 | 1 | ST-10 | 3410253 |
| | Valve Body Screen | 76-on | 1 | 817-Q | 3878313 |
| | Governor Screen | 68-on | 1 | 848-Q | 3743519 |
| | Filter Kit - large Dacron | 66-on | 1 | 710-QX | - |
| | - small Dacron | 60-on | 1 | 784-QX | - |
| | - large brass | 66-on | 1 | 711-QX | - |
| | - small brass | 60-on | 1 | 787-QX | - |
| | - A727 & A904 combo | 60-on | 1 | 490-QX | - |

BANDS

| | | | | | |
|----|--|-------|---|---------------|---------|
| B1 | Kickdown Band (front) - solid | 60-61 | 1 | BT-33 | 2124595 |
| | - solid | 61-on | 1 | BT-34 | 2204792 |
| | - flex | 61-91 | 1 | BT-40 | 4202522 |
| | - semi-flex | 82-91 | 1 | BT-40A | 4531221 |
| | - semi-flex | 92-on | 1 | BT-72 | 4617849 |
| | - solid - offset | 76-on | 1 | BT-85 | 3681921 |
| D7 | Reverse Band (rear) - 1.375" solid | 60-on | 1 | BT-32 | 4443187 |
| | - 2.00" split | 68-on | 1 | BT-52 | 4443183 |

HARD PARTS - NEW

| | | | | | |
|-------------------|----------------------------|-------|---|----------------|---------|
| PUMP PARTS | | | | | |
| A7 | Front Pump Rotor Set | 60-on | 1 | 8299-Q | 3780238 |
| | - milled flats | 92-on | 1 | K12762C | - |

CHRYSLER

A904, A998, A999

| ILL | DESCRIPTION | YEARS | QTY | FATSCO | REFERENCE |
|-------------------------------------|---|-------|-----|----------------|-----------|
| SPRAGS & ROLLER CLUTCHES | | | | | |
| E2 | Spring & Roller Kit - long roller | 65-on | 1 | 8543-QX | 2808672 |
| | - short roller | 60-64 | 1 | 8541-QX | 2808673 |
| | Cam & Retainer Kit - overrunning clutch | 60-64 | 1 | 8185-Q | 2279960 |
| | - overrunning clutch | 65-on | 1 | 8186-Q | 2808637 |
| | - bolt in type - case repair | 65-on | 1 | 9592-Q | N.L. |
| | Retainer, Overrunning Clutch | 65-on | 1 | 9400-Q | 2464443 |
| SPRINGS | | | | | |
| C6 | Disc Spring, Rear Clutch Piston | 60-on | 1 | 8608-Q | 1942414 |
| | Spring & Plate Kit - lock-up | 78-on | 1 | 9502-Q | 4186185 |
| SNAP RINGS | | | | | |
| 6 | Direct - .060" | 60-on | 1 | 12111-Q | 1942421 |
| | - waved | 60-on | 1 | 12112-Q | 3410571 |
| 10 | Forward - .043" waved | 60-on | 1 | 12113-Q | 2466283 |
| | - .060" | 60-on | 1 | 12114-Q | 1942421 |
| | - .062" waved | 60-on | 1 | 12115-Q | 2801626 |
| | - .076" | 60-on | 1 | 12116-Q | 1942423 |
| | - .098" | 60-on | 1 | 12117-Q | 2538617 |
| MISCELLANEOUS | | | | | |
| | Overrun Clutch Race | 68-on | 1 | 12962 | 3515628 |
| | Output Shaft Plug - nipple | 78-on | 1 | 96155 | 4130008 |
| | Brass Fitting, Cooler Line | 62-on | 2 | 9625-Q | - |
| | Filler Tube Repair | 62-on | 1 | 91640 | - |
| | Grommet, Torque Shaft Bushing - plastic | 72-on | 1-2 | 9622-Q | 3467800 |
| | Grommet, Upper & Lower Control Rod - plastic .. | 60-on | 2-4 | 9303-Q | 3575333 |
| ELECTRICAL COMPONENTS | | | | | |
| E3 | Switch, Neutral Safety - short | 78-on | 1 | 8235-Q | 4057750 |
| | | 69-77 | 1 | 8014-Q | 2932820 |
| | | 65-68 | 1 | 8003-Q | 2495537 |
| | | 60-64 | 1 | 8001-Q | 1704283 |
| | Case Connector | 86-on | 1 | 12608 | - |
| | Converter Clutch Solenoid | 86-on | 1 | 12605 | 4348719 |
| REBUILT / USED HARD PARTS | | | | | |
| A8 | FRONT PUMP ASSEMBLY | 60-67 | 1 | 904-01 | |
| | FRONT PUMP ASSEMBLY | 68-77 | 1 | 904-01A | |
| | FRONT PUMP ASSEMBLY W/BEVEL BACK | 75-77 | 1 | 904-01B | |
| | FRONT PUMP ASSEMBLY – NON LOCK UP | 78-92 | 1 | 904-01C | |
| | FRON PUMP ASSEMBLY – LOCK UP | 78-92 | 1 | 904-01D | |
| 1 | DIRECT DRUM | 60-71 | 1 | 904-05 | |
| | DIRECT DRUM – 3 PACK | 72-92 | 1 | 904-05A | |
| | DIRCET DRUM – 4 PACK | 72-92 | 1 | 904-05B | |
| | DIRECT DRUM – 5 PACK | 72-92 | 1 | 904-05C | |

| | | | | |
|----|-------------------------------------|-------|---|---------|
| 2 | DIRECT PISTON | 60-ON | 1 | CALL |
| 7 | FORWARD CLUTCH DRUM – 18 SPLINE | 60-67 | 1 | 904-06 |
| | FORWARD CLUTCH DRUM | 68-ON | 1 | CALL |
| 8 | FORWARD PISTON | 60-ON | 1 | CALL |
| 12 | FRONT RING GEAR HUB – EARLY RATIO | 60-ON | 1 | 904-13 |
| | FRONT RING GEAR HUB W/BUSHING | 60-ON | 1 | 904-13A |
| | FRONT RING GEAR HUB W/O BUSHING | 60-ON | 1 | 904-13B |
| | FRONT RING GEAR HUB – LOW RATIO | 60-ON | 1 | 904-13C |
| 13 | FRONT PLANETARY – 3 PIN – 23 SPLINE | 60-ON | 1 | 904-10 |
| | FRONT PLANETARY – 3 PIN – 24 SPLINE | 60-ON | 1 | 904-10A |
| | FRONT PLANETARY – 4 PINION ALUMINUM | 60-ON | 1 | 904-10B |
| | FRONT PLANETARY – 3 PININ STEEL | 60-ON | 1 | 904-10C |
| | FRONT PLANETARY – 4 PINION STEEL | 60-ON | 1 | 904-10D |
| | FRONT PLANETARY – LOW RATIO | 60-ON | 1 | 904-10E |
| 14 | SUN SHELL | 60-ON | 1 | 904-22 |
| | SUN SHELL – LOW RATIO | 60-ON | 1 | 904-22A |
| D5 | SUN GEAR | 60-ON | 1 | 904-19 |
| | SUN GEAR – LOW RATIO | 60-ON | 1 | 904-19A |
| 17 | REAR PLANETARY – 3 PIN ALUMINUM | 60-ON | 1 | 904-11 |
| | REAR PLANETARY – 4 PIN ALUMINUM | 60-ON | 1 | 904-11A |
| | REAR PLANETARY – 3 PIN STEEL | 60-ON | 1 | 904-11B |
| | REAR PLANETARY – 4 PIN STEEL | 60-ON | 1 | 904-11C |
| 18 | REAR RING GEAR | 60-ON | 1 | 904-14 |
| | REAR RING GEAR | 60-ON | 1 | 904-14A |
| 21 | REVERSE DRUM – SHORT SPLINE | 60-64 | 1 | 904-07 |
| | REVERSE DRUM – LONG, FINE SPLINE | 65-71 | 1 | 904-07A |
| | REVERSE DRUM – COARSE SPLINE | 70-ON | 1 | 904-07B |
| 22 | TRANSMISSION CASE | 60-ON | 1 | CALL |
| 24 | GOVERNOR | 60-ON | 1 | 904-32 |
| 25 | OUTPUT SHAFT | 60-ON | 1 | CALL |
| 26 | EXTENSION HOUSING | 60-ON | 1 | CALL |
| 27 | TRANSMISSION OIL PAN | 60-ON | 1 | CALL |
| | REAR PUMP ASSEMBLY | 60-65 | 1 | 904-60 |
| | REAR OUTOUT SUPPORT – 4 BOLT | 66-89 | 1 | 904-34 |
| | REAR OUTPUT SUPPORT – 6 BOLT | 90-ON | 1 | 904-34A |
| 28 | PARK CABLE HOUSING ASSEMBLY | 60-65 | 1 | 727-62 |
| | VALVE BODY | 60-61 | 1 | 904-33 |
| | VALVE BODY | 62-64 | 1 | 904-33A |
| | VALVE BODY | 1965 | 1 | 904-33B |
| | VALVE BODY | 66-68 | 1 | 904-33C |
| | VALVE BODY | 69-71 | 1 | 904-33D |
| | VALVE BODY | 71-72 | 1 | 904-33E |
| | VALVE BODY | 72-ON | 1 | 904-33F |
| | VALVE BODY – L/U W/TUBE | 78-ON | 1 | 904-33G |
| | VALVE BODY – L/U. 1 WIRE SOLENOID | 87-ON | 1 | 904-33H |
| | VALVE BODY – L/U, 2 WIRE SOLENOID | 94-ON | 1 | 904-33I |
| | FRONT SERVO ASSEMBLY | 60-ON | 1 | CALL |
| 30 | REAR SERVO ASSEMBLY | 60-ON | 1 | CALL |

CHRYSLER

A904, A998, A999

| ILL | DESCRIPTION | YEARS | QTY | FATSCO | REFERENCE |
|-----|-------------|-------|-----|--------|-----------|
| | | | | | |

